

TOP FLOOR

BOLSTER CPT DOWN EITHER SIDE OF FIRE PLACE WHERE PEOD

S28811
MILLIS

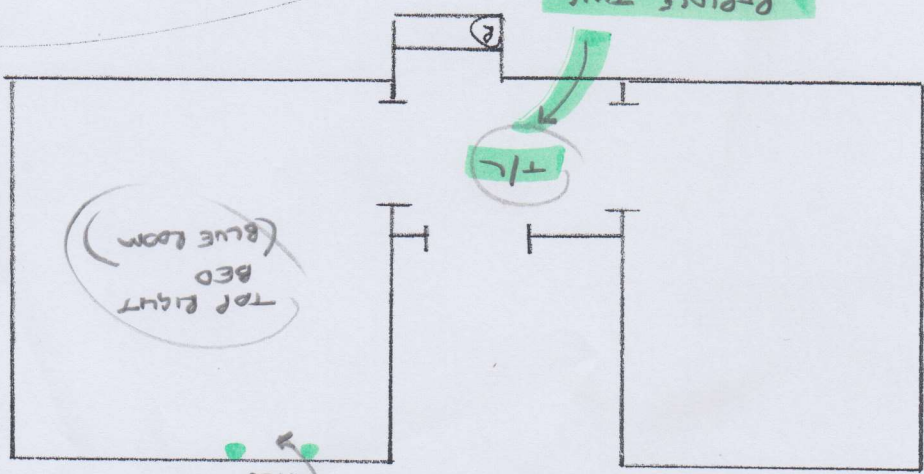

PLAN 13TH DEC
PLAN PLEASE MAKE SURE ALL 10 POINTS ARE COMPLETED AND THE CUSTOMER IS HAPPY BEFORE LEAVING + FURTHER ISSUES ON EMAIL ATTACHED

MAIN STAIRS

PULL BACK MIDDLE STAIR TO INSPECT ISSUE ON RIGHT HAND SIDE. IS W/AY MISSING. (6TH STAIRS DOWN)

REPLACE THIS CPT IN W/HOUSE HOLE UP

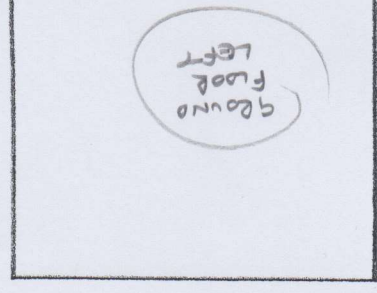

FIT 6m SHIM HERE AND CE-FIT WITHOUT A BAL

FIT 6m SHIM HERE AND CE-FIT WITHOUT A BAL

FINISH OFF CPT HERE AND PIECE IN SMALL FILTERS

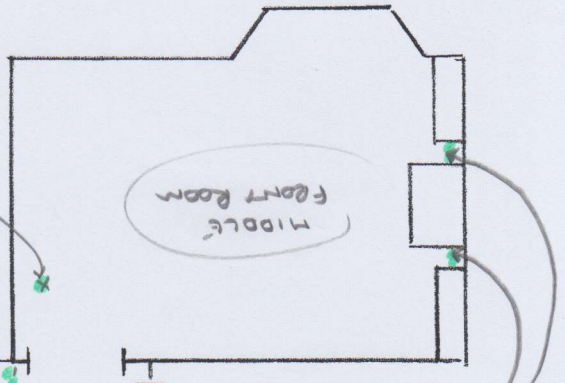

REPLACE AND SQ EDGE AROUND COIL

FIT CPT ON AND AROUND THIS C/P.

BASEMENT STAIRS
FIT BASEMENT STAIRS
ALREADY REPEPPED CPT
IS ON SITE.

PULL BACK CPT, GIVE A SMALL PIECE OF SEAM TAPE ON BACK THEN PUSH THE PIPE INTO PLACE AND CE-FIT