

- 3x BEDS TO MOVE
- NO UPLIFT
- BRUSHED CHROME DOOR HANDLES.
- 12cm GAP SHOWING G ON RUNNER WITH 2" OF TAPE SHOWING
- FLEX UTILITY
- TWO ROWS OF GRIPPER TO MASTER BED

18/01/17

2x STAIRS =  $43 \times 85$

W1 =  $62 \times 96$

W2 =  $71 \times 120$

W3 =  $72 \times 81$

9x STAIRS =  $85 \times 42$

BIN =  $43 \times 106$

(14.50 UN M OF TAPE)

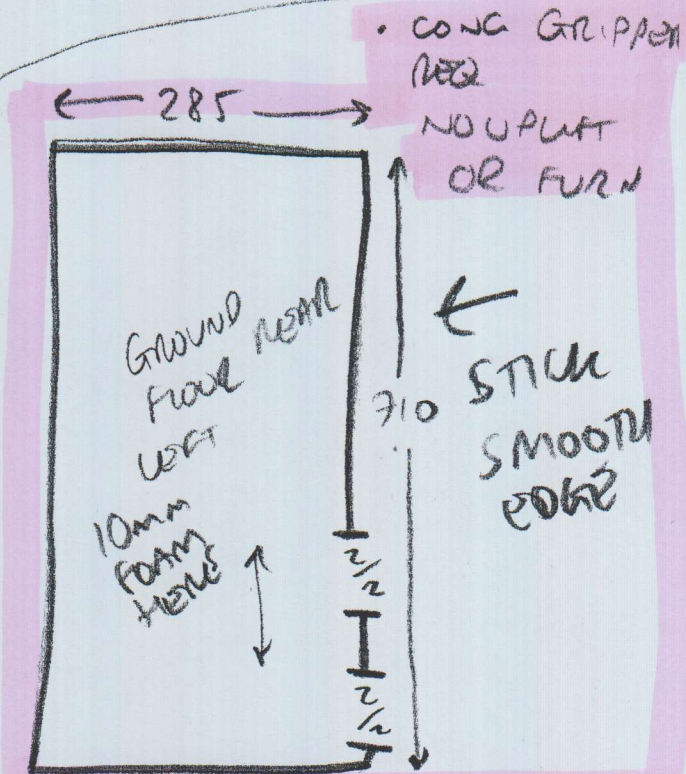

18/01/17 STAIRS + G/F ROOM

660

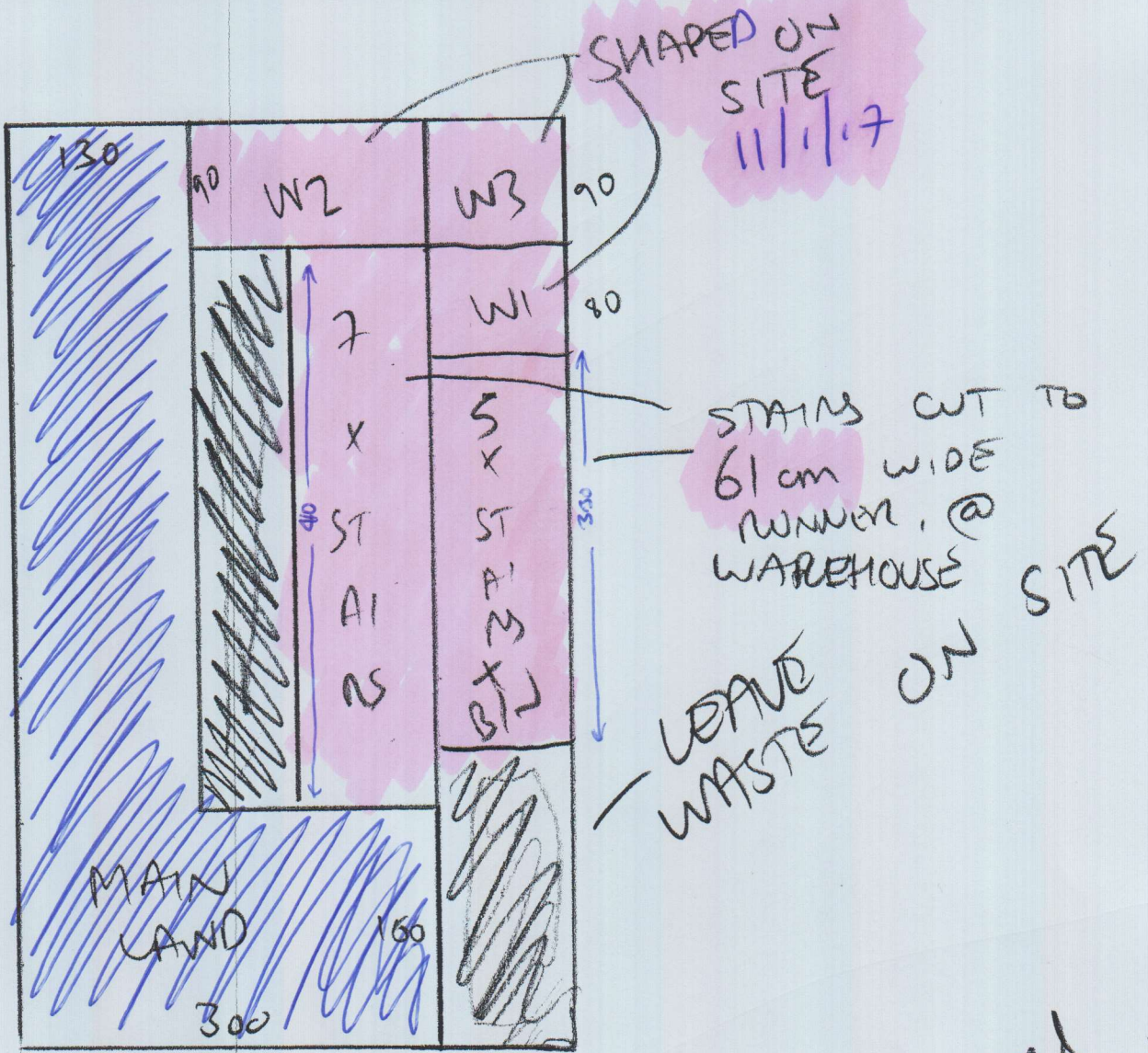

CUTTING PLAN

6.6 x 4.00

~~BED 1 = 3.50 x 4~~

~~BED 2 = 3.70 x 4m~~

~~GUEST = 4.70 x 4m~~

GROUND FLOOR = 7.20 x 4.00

~~MASTER BED = 5.50 x 5.00~~

DIFFERENT CRT

SEE NEW BREAKDOWN SHEET