

MACEDONIA



WFT FLIGHT (MACEDONIA)

TOP LAND = 132 OR x 80

W1 = 64 x 84 ✓

W2 = 68 x 100 ✓

W3 = 70 x 73 ✓

- FOLD ON OPEN EDGE



1/2 LAND = 107 OR x 102

SX STAIRS = 48 x 70 ✓

W4 = 58 x 79 ✓

W5 = 61 x 97 ✓

W6 = 60 x 100 ✓

BLN = 60 x 85 ✓

- SILVER 2 1/2 TO MAIN LAND (B)
- LOFT + MAIN FLIGHT IN MACEDONIA
- ~~SPOT TO 28x100 STAIRS~~

Job No: _____
 Tel: TIE UP TO 1/2 LAND
 Sheet: +12mm SHIM

BASEMENT STAIRS

1/4 LAND = 100 OR x 83 ✓

10x STAIRS = 40 x 82 ✓

W8 = 63 x 92 ✓

LOBBY = 84 x 90 ✓

↓
 BUILT IN BOOKSHELF
 HERE, CUT AROUND

GREEN +
 BLUE +
 ORANGE
 STRIPE

PI PAPER REQ.



MAIN STAIRS (MACEDONIA)

MAIN LAND (A) = 205 OR x 110

2x STAIRS = 41 x 95 ✓



SILVER

MAIN LAND (B) = 288 x 184 (W)

W7 = 110 x 90 ✓

11x STAIRS = 43 x 85 ✓

↓
 TO FRONT DOOR

Job No:

Name: **MICKS**

Address:

Tel:

Sheet: of:

KITCHEN

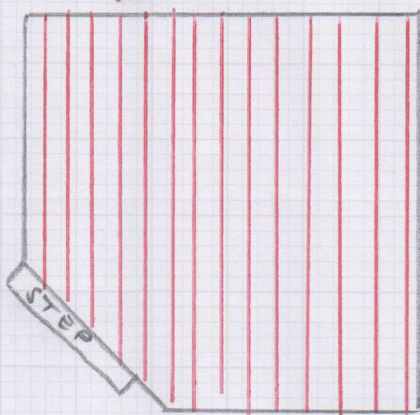

MAIN LAND
③

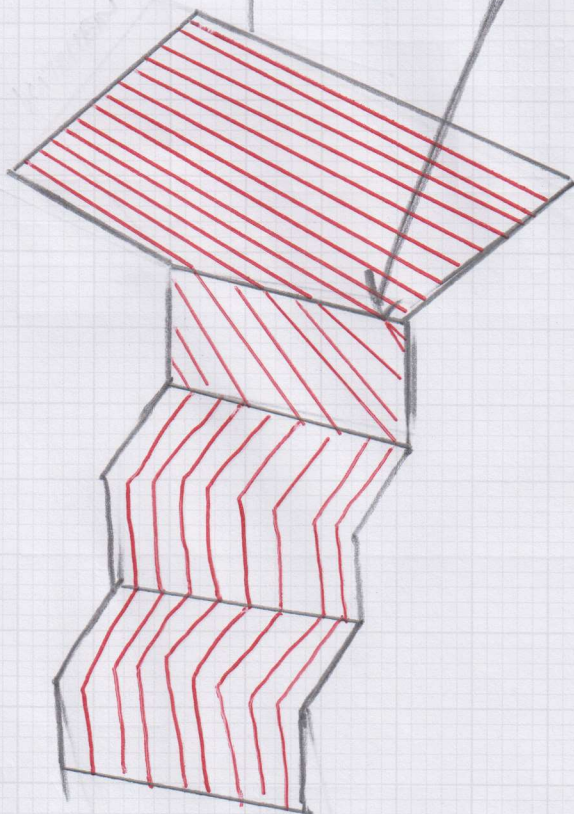

CUST AWARE CPT
WILL RUN AT ODD
ANGLE HERE

SHIM + TILE UP TO
LOFT FLOOR TILES

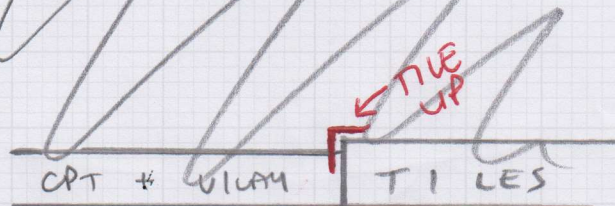

CPT + W/AM

TILES

MAIN + LOFT STAIRS

Job No: _____
 Name: _____
 Address: _____
 Tel: _____
 Sheet: _____ of: _____

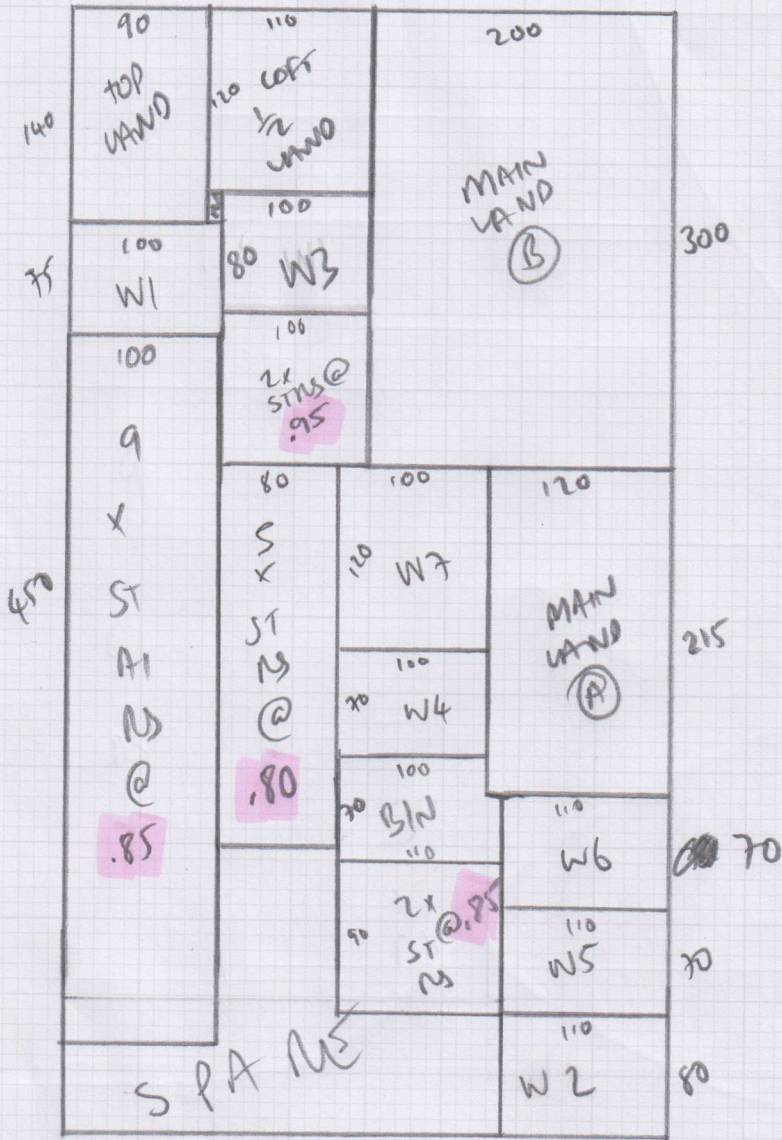

MACEDONIA
 6.35 x 4.00m

(MAKE SURE YOU
 MATCH UP STAIR
 WIDTHS WITH CORRECT
 STAIR ON THE
 FLOOR PLAN)

BASEMENT STAIRS

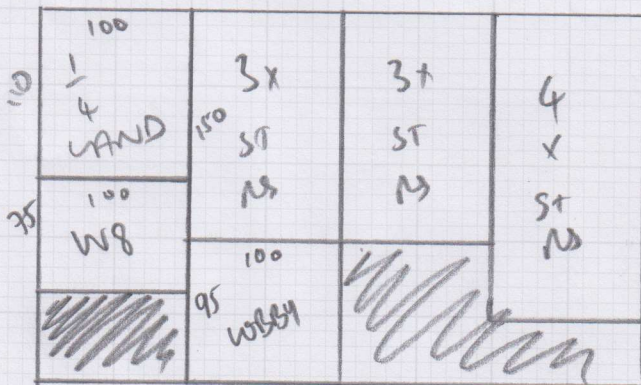

2.45 x 4.00m

ROCK 'N' ROLL
 GREEN, BLUE +
 ORANGE STRIPE