

- GOING DOWN ON EXISTING WOOD
 - NEW SMOOTHEDGE - DAM, NO PIA
 - GOLD PIGAN
 - NO UPST, FURN MOVE x1.5 PER ROOM
- £ 2.80 PER HOUR PARKING

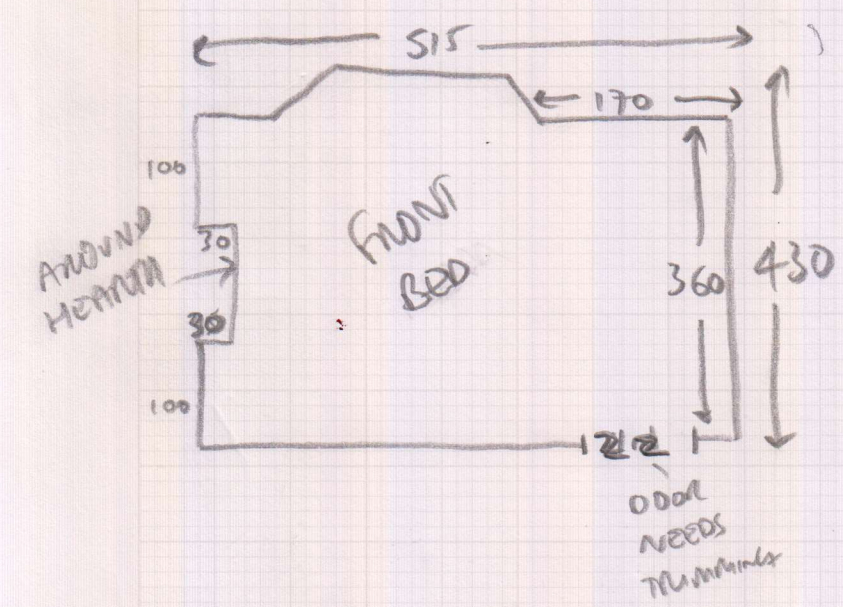

- 5 1/2 STAIRS = 42 x 75 (56 RUNNER)
- 10 x STAIRS = 42 x 77 (56 RUNNER)
- 3 1/2 STAIRS = 42 x 79 (58 RUNNER)
- 10 1/2 STAIRS = 43 x 82 (58 RUNNER)
- BIN 1 = 45 x 100 (SP)
- BIN 2 = 70 x 120 (SP)

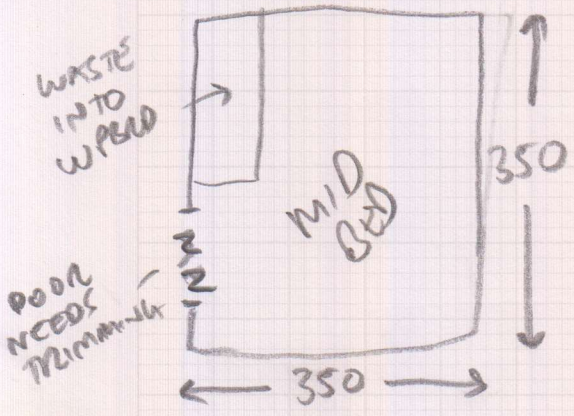
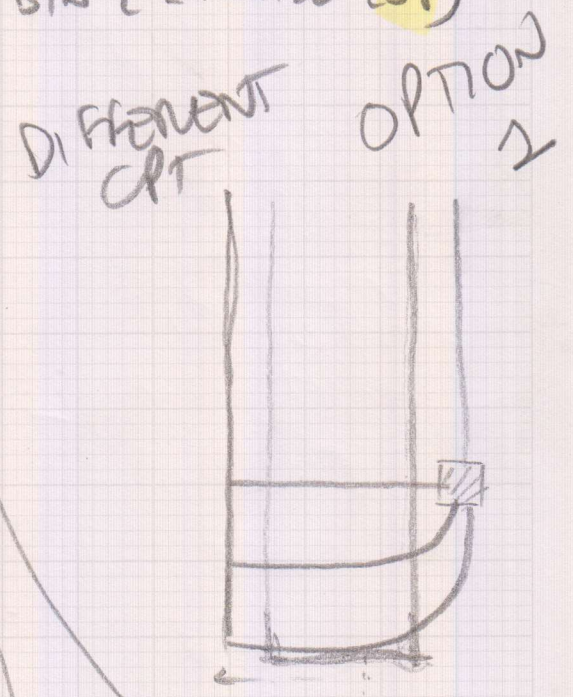

BASEMENT STAIRS

- 1/2 USER = 18 x 63
- W1 = 55 x 75
- W2 = 60 x 92
- W3 = 63 x 67
- 6 x STAIRS = 43 x 68

DIFFERENT CPT

OPTION 3

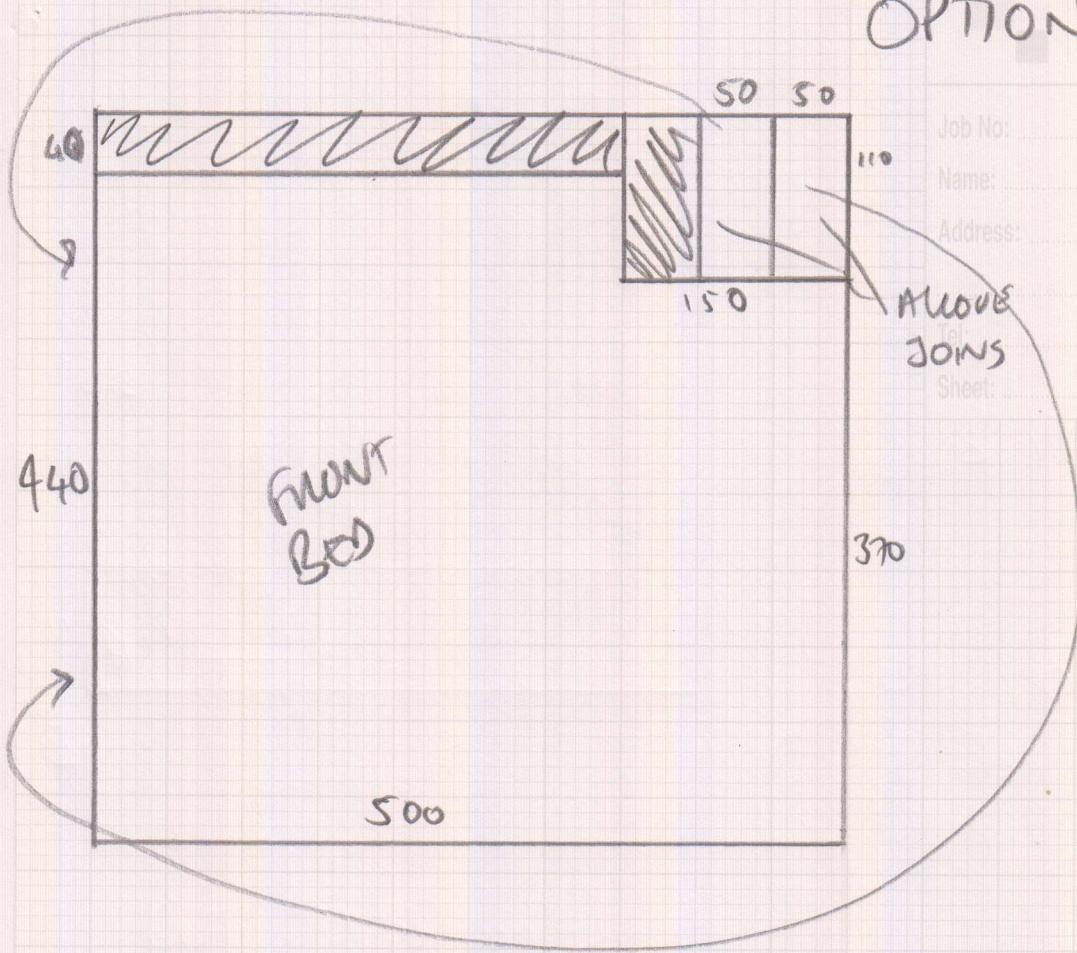

FRONT BED - 480 x 5m

MID BED - 3.60 x 4m

REAR BED - 3.35 x 4m