

MACEDONIA

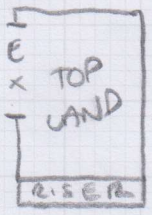

TOP LAND = 132 OR x 80

W1 = 64 x 84 ✓

W2 = 68 x 100 ✓

W3 = 70 x 73 ✓

- FOLD ON OPEN EDGE

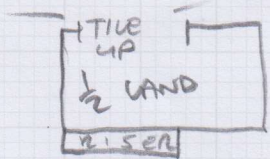

1/2 LAND = 107 OR x 102

SX STAIRS = 48 x 70 ✓

W4 = 58 x 79 ✓

W5 = 61 x 97 ✓

W6 = 60 x 100 ✓

BLN = 60 x 85 ✓

- SILVER 2/2 TO MAIN LAND (B)
- LOFT + MAIN FLIGHT IN MACEDONIA
- ~~PAPER TO BASEMENT STAIRS~~

Job No:
 • NEW WOOD PIN
 • NEW UCLAY
 • POLISHED CHROME
 Tel: TILE UP TO 1/2 LAND
 Sheet: +12mm SHIM

WFT FLIGHT (MACEDONIA)

BASEMENT STAIRS

1/4 LAND = 100 OR x 83 ✓

10x STAIRS = 40 x 82 ✓

W8 = 63 x 92 ✓

LOBBY = 84 x 90 ✓

↓
 BUILT IN BOOKSHELF HERE, WT AROUND

GREEN + BWF + ORANGE STRIPE

+12mm SHIM, BUT UP TO TILE UP

PI PAPER REQ.

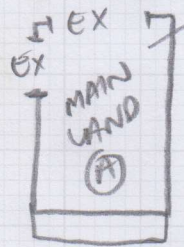

MAIN STAIRS (MACEDONIA)

MAIN LAND (A) = 205 OR x 110

2x STAIRS = 41 x 95 W



MAIN LAND (B) = 288 x 184 (W)

W7 = 110 x 90 ✓

11x STAIRS = 43 x 85 ✓

↓
 TO FRONT DOOR

SEE DIAGRAMS FOR THIS LANDING!!!

MAIN + LOFT STAIRS

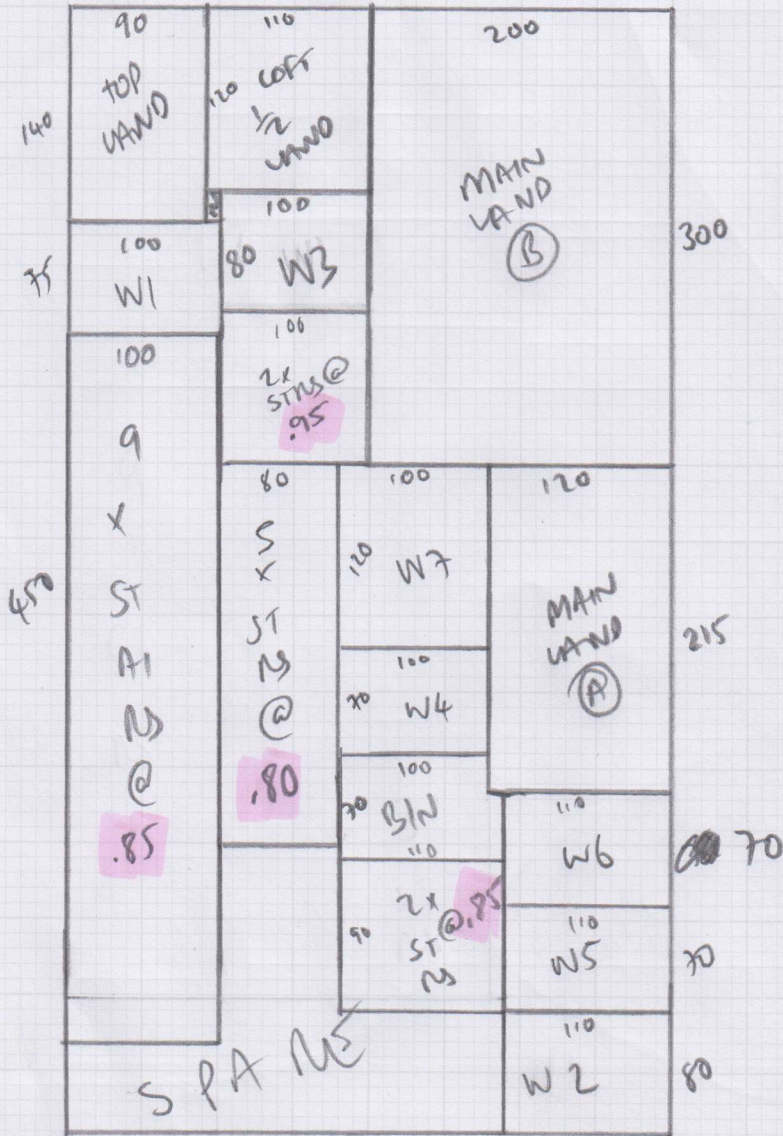

Job No:

Name:

Address:

Tel:

Sheet: of:

MACEDONIA

6.35 x 4.00m

(MAKE SURE YOU MATCH UP STAIR WIDTHS WITH CORRECT STAIRS ON THE FLOOR PLAN)

BASEMENT STAIRS

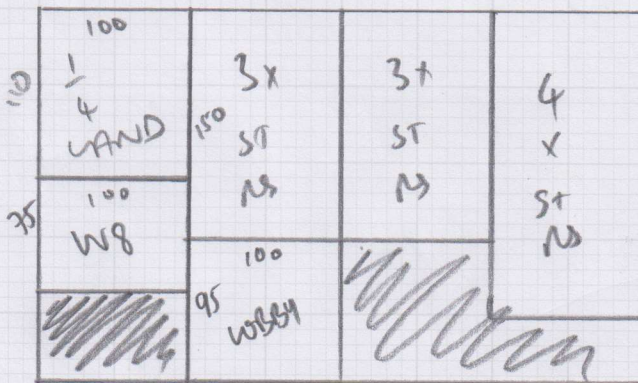

2.45 x 4.00m

ROCK 'N' ROLL
GREEN, BLUE +
ORANGE STRIPE

Job No:

Name: *Hicks*

Address:

Tel:

Sheet: of:

