

Job No:

Address:

Tel:

Sheet: of:

$2 + \frac{1}{2}$  STAIRS = 40x80 - 60 cm RUNNER

✓ W1 = 59x94

✓ W2 = 70x107

✓ W3 = 65x70

✓ 8x STAIRS = 41x73

✓ BIN = 37x100

} 53 cm RUNNER

NO UPST

SOFFITS AS RUNNER

NEW GRIPPER + ULLAH AREA

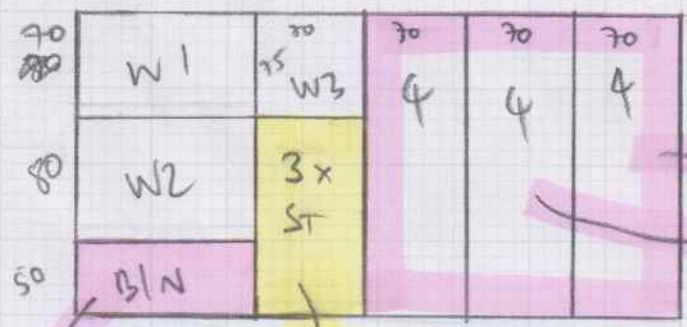

2m x 4m

53cm RUNNER

53cm RUNNER

60cm RUNNER

TEMPLATE WINDERS ON SITE

- VERY WEAK RISERS - CHARACTER FIXING
- DOOR BAR TO BE FINISHED IN UN-IDEAL POSITION

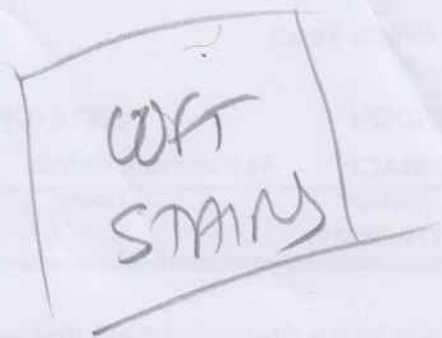
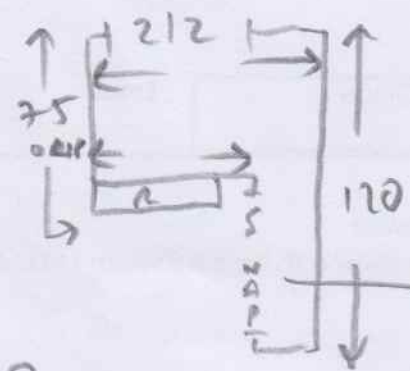

$2 \frac{1}{2} \times \text{STMS} = 45 \times 60$

$W 2 = 56 \times 82$

$W 2 = 64 \times 105$

$W 3 = 50 \times 67$

$6 \times \text{STAINS} = 45 \times 68$

$\frac{1}{4} \text{ WAND} = 96 \text{ dia} \times 68$

$2 \times \text{STAINS} = 45 \times 61$

~~DEFINITE SITE TEMPERATURE~~  
**FULL WIDTH!!**

~~BASE ON FINE LOOP 1489~~

