

1

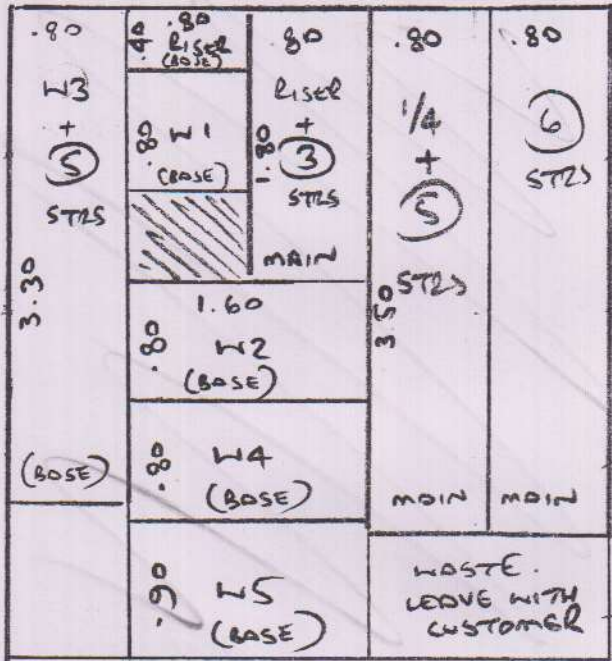

S29552
Cook

STRIPE RUNNER

PLAN 1 4.30 x 4m

17.2m²

MAIN STAIRS = 65cm WIDE
BASEMENT = 62cm WIDE

SEE RUNNER CHECK LIST FOR WINDER SHAPE

2

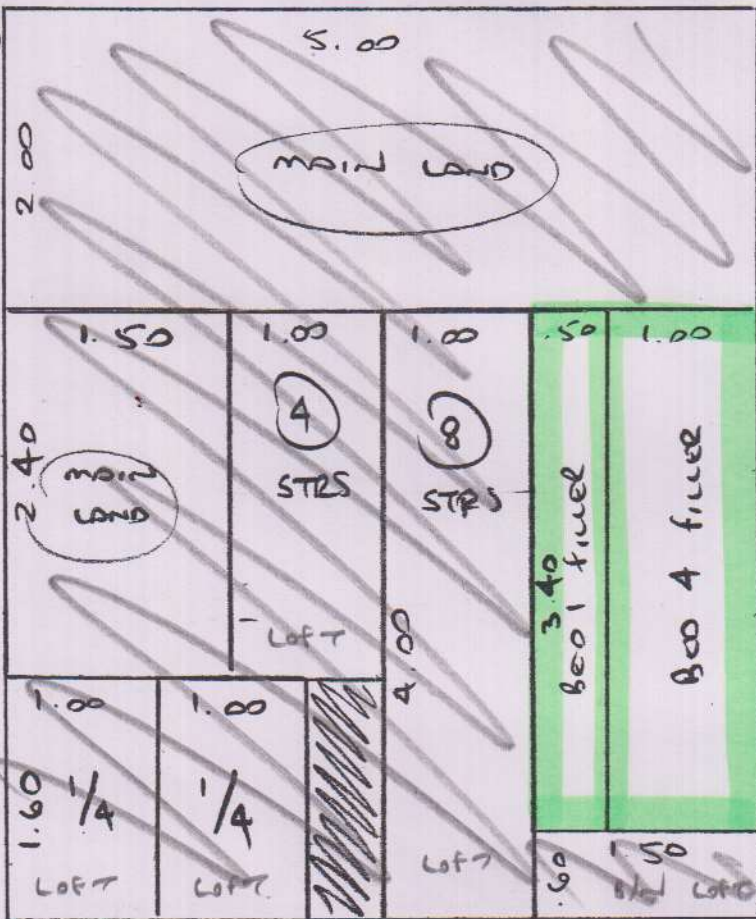

RIB.

BED 1 3.40 x 5m

BED 4 3.40 x 5m

(SEAM TO BAY IN)
BEDS 1 + 4

BED 2 3.40 x 5m

BED 3 3.60 x 5m

PLAN 2 6.00 x 5m

19.80 x 5m

99m²

ALAN PURSE 1

FIT ALL ROOMS +
TEMPLATE RUNNERS

OPTION 2
- STRIPE TO MAIN +
BASEMENT (RUNNERS)
- 4 BEDS, TOP STAIRS +
TOP LAND IN A RIB

COOK

ALL AREAS

- WOOD FLOORS
- NO U/D
- NO M/F
- NEEDS S/E

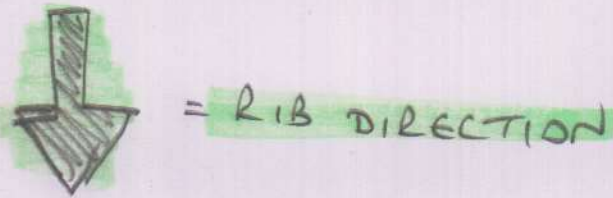
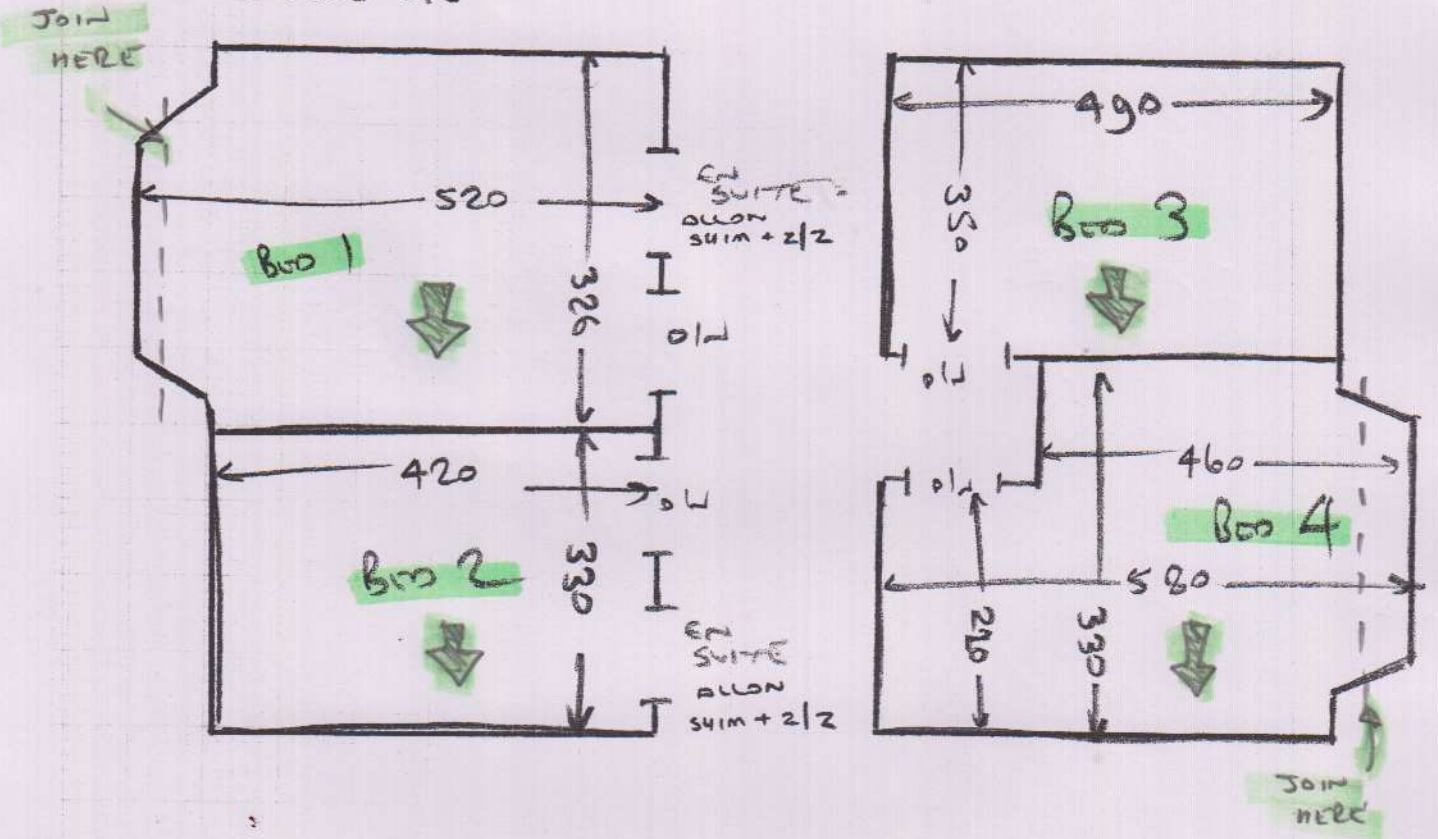

TOP STAIRS (fully fitted)

COOK

Riser	20	85
3 e	45	85
1/4	110	86
5 e	45	86
1/4	109	88
4 e	45	88
B/L	46	108

ALL NEEDS

- WOOD FLOOR
- NO U/L
- NEEDS S/E

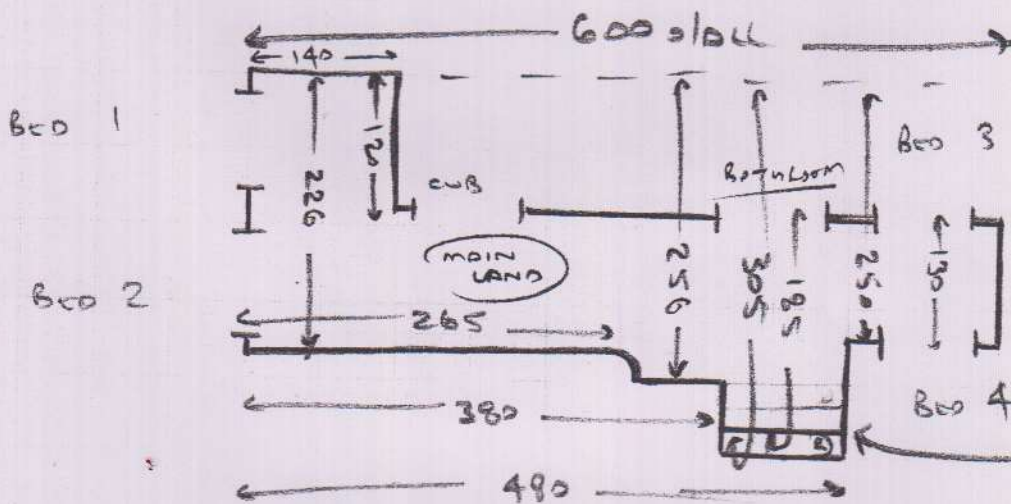

main STAIRS (65cm runner)

Riser	20	85
3 e	45	85
1/4	107	87
9 e	45	85
OK	45	runner
B/L	45	runner

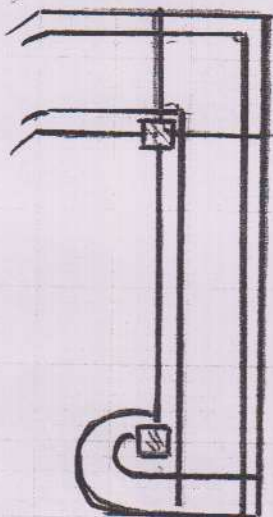

Basement STAIRS (62cm runner)

Riser	20	37
W1	65	90
W2	70	111
W3	77	82
5 e	46	82
W4	67	92
W5	77	114

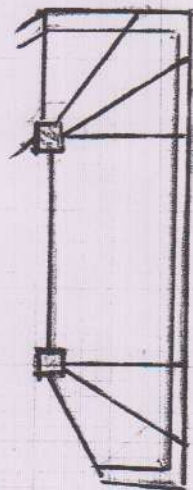

Runner Check List

S29552
Cook.

1/4's :

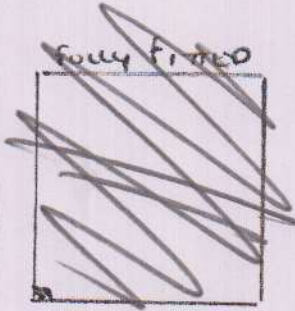
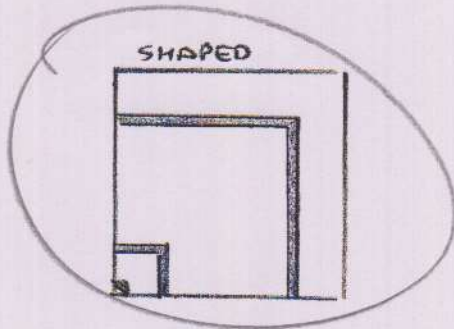

~~1/2's :~~

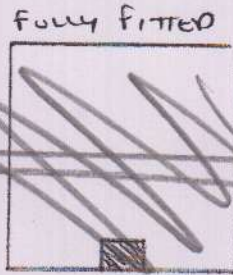
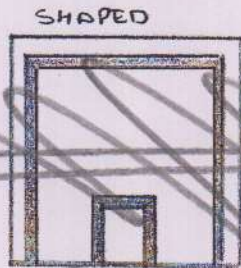

2/3

WINDERS :

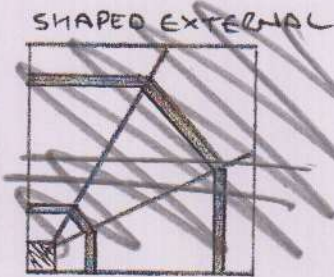
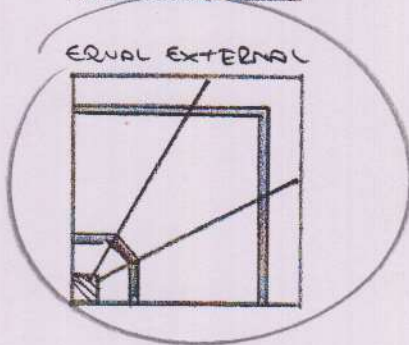

Runner width on STRAIGHTS

65 cm main
62 cm element

EDGING SELECTED

TAPE CALIBRA 3045

IF TAPE. AMOUNT VISIBLE / SHOWING

2.5"

ALON
Phase 1