

Nov 16/4
 S 29926

PINNINGTON

(2) VINTAGE
 ISSUES

☺ OF ☺

NOTE: LOOSE FLOOR BOARDS
 TO ALL AREAS
 THAT CUSTOMER
 SAID WILL DEAL
 WITH PRIOR TO
 NEW FLOORING
 BEING LAID.

1.15 x 3 ✓

w/c

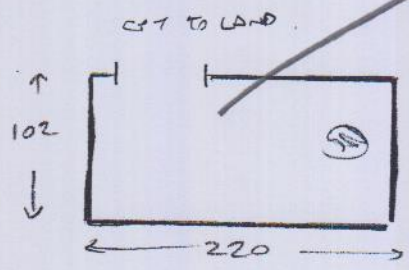

- wood floor
- u/g c/p
- ~~needs mtb~~

EXISTING
 SUB
 FLOOR ✓

bottom entry

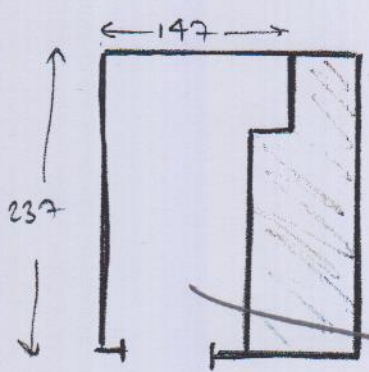

- wood floor
- u/g c/p
- ~~needs slk~~

1.60 x 3 ✓

CPT TO LAND

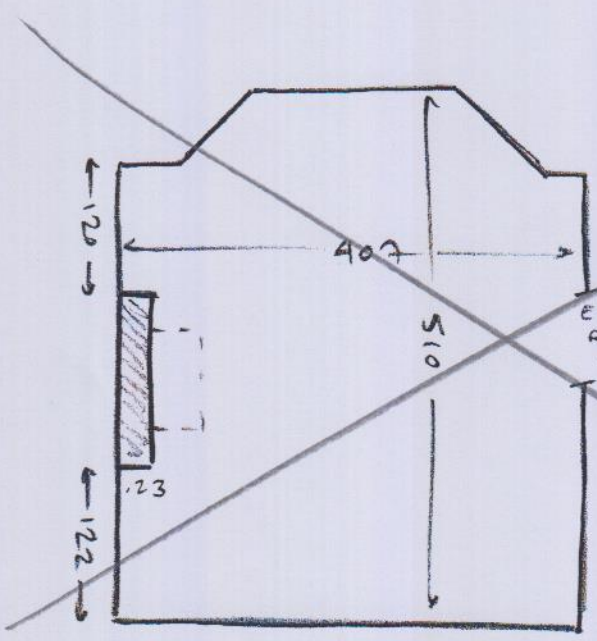

- wood floor
- u/g c/p
- ex slk

- mt 3 UNITS (including 1 x UPRIGHT PIANO)