

CRT TO GO UP SKIPPING  
 AS DIAGRAM SHOWS  
 STUCK CLIPPER AS CONC  
 SUBFLOOR  
 BRUSHED CHROME 2 1/2  
 NO DELS OR STUFF

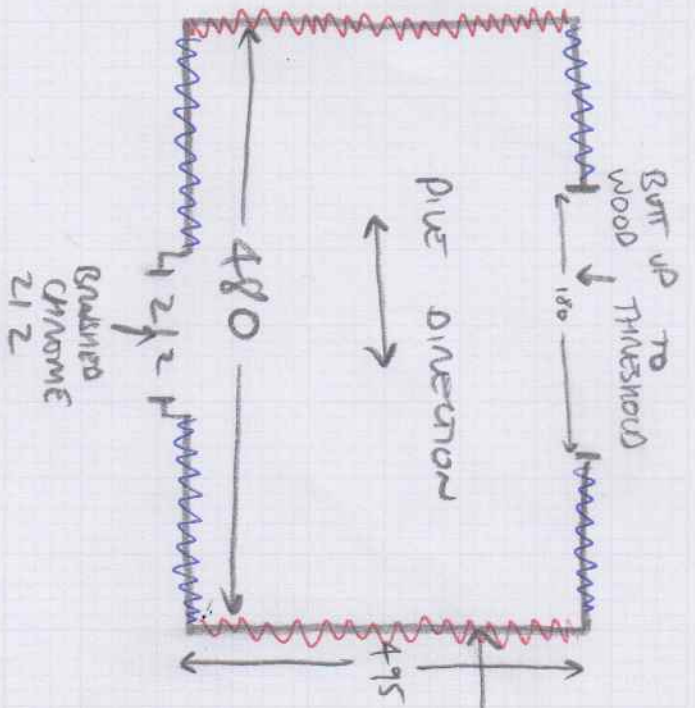

WALLS MARKED WITH  
 Wavy → CRT TO GO UP WALL  
 ONE PIECE  
 20 cm

WALLS MARKED WITH Wavy  
 CRT TO BE SEPARATE PIECES  
 ON THE WALL -  
 PIE DIRECTION OF THESE  
 PIECES WILL BE OPPOSITE  
 DIRECTION, CUT AHEAD

Job No: \_\_\_\_\_  
Name: \_\_\_\_\_  
Address: \_\_\_\_\_  
City: \_\_\_\_\_  
State: \_\_\_\_\_

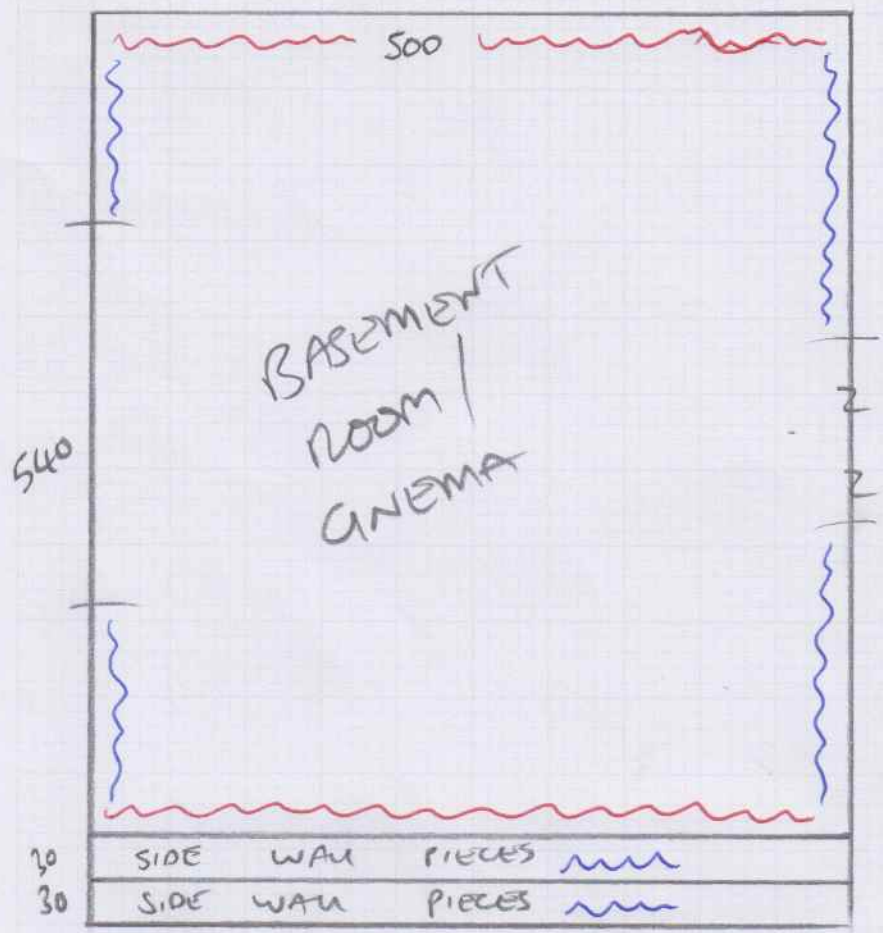

$$\begin{array}{r} 540 \times 500 \\ + 60 \times 500 \\ \hline 600 \times 500 \end{array}$$