

Ray (Tues)  
5/2

(S) 30614  
BROMFIELD

(1) of (1)

LAYOUT

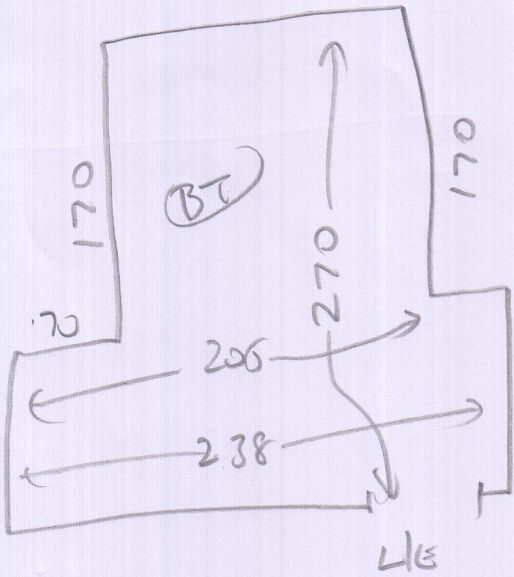

$$2.40 \times 1.00 = 2.40$$

$$1.30 \times 1.70 = \frac{2.21}{4.70}$$

$$71.1 = 5.17 \text{ m}^2$$

Wood  
w/ ext hns + screed concrete  
needs ply  
4 PK  
4 Brm

SPACIA

4"

LVT PLANKS

2 Boxes

SSM

N-TIGHT

~ \*