

①

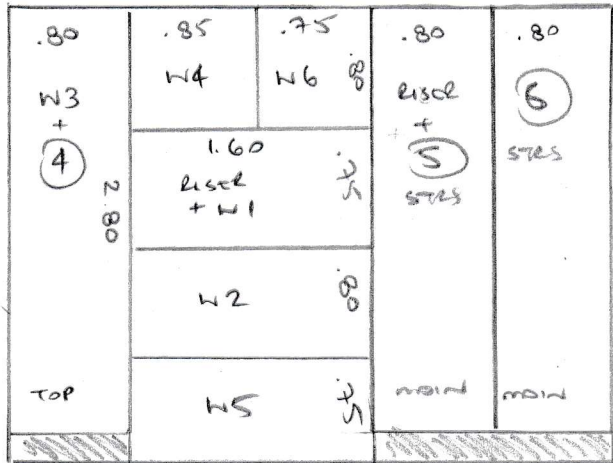

S31424
BANKS.

PLAN ① 3.10 x 4.00

TEMPLATE LEFT STAIRS:

- FIXED PERIMETER WINDERS
- STRAIGHTS 56cm WIDE

CUT MAIN STAIRS:

- 59cm WIDE

BANKS

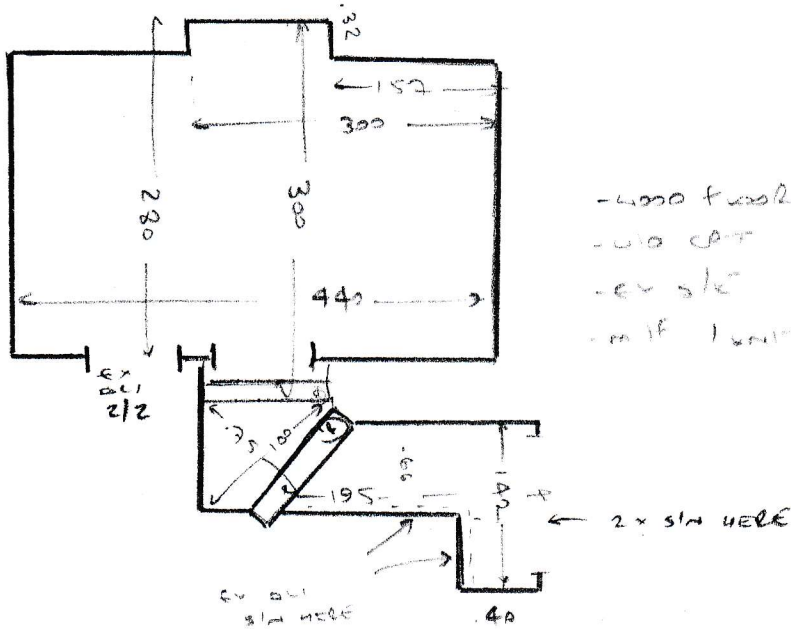

- wood floor
- no cat
- ev s/e
- m/f unit

LOFT STAIRS

- ✓ Riser 20 75
- ✓ W1 65 83
- ✓ W2 70 103
- ✓ W3 70 70
- ✓ W4 45 70
- ✓ W4 62 80
- ✓ W5 65 95
- ✓ W6 67 67

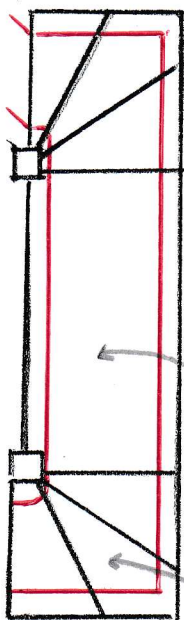

56cm
WIDE
STRAIGHTS

FIXED PERIMETER
WINDOWS

MAIN STAIRS

- ✓ Riser 20 73
- ✓ 10 e 45 73
- ✓ 81w 46 95

59cm
WIDE
STRAIGHTS

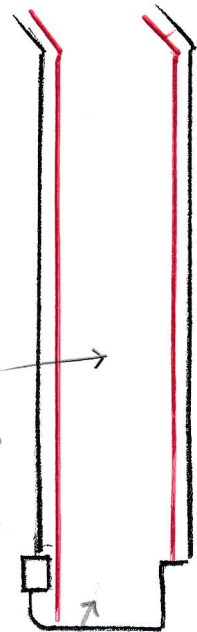

FINISH THIS STEP OVER
RISER AS NORMAL
WITH TAPE STOPPED
ON TREAD DUE TO WALL

STAIRS

- wood floors
- no v/a
- needs s/e