

S31619

Mrs M. Wicks  
19 Milton Road  
E Sheem  
SW14 8JP

Wood Herringbone

8.80 x 4m

SITE TEMPLATE  
17/3

Runners to cut

Top stairs

- Riser + ① 55cm wide x 0.85 long
- W3 + ③ 51cm wide x 2.20m long
- W6 + ② 55cm wide x 1.75m long

Bottom stairs

- Riser + ② 59cm wide x 1.25m
- W9 + ④ 52cm wide x 4.75m

(10/22)

531619

Job No:

Name: WICKS

Address:

Tel:

Sheet: (2) of (4)

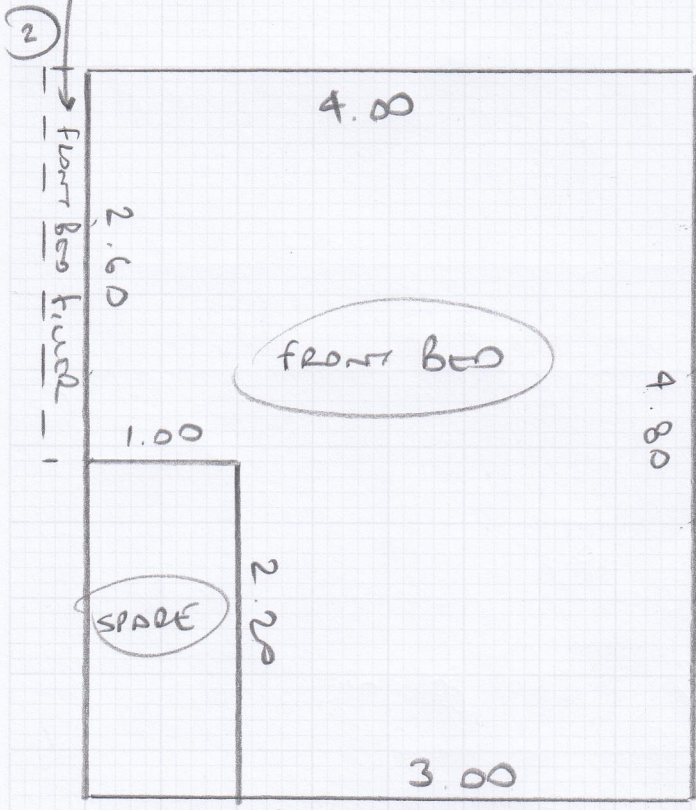
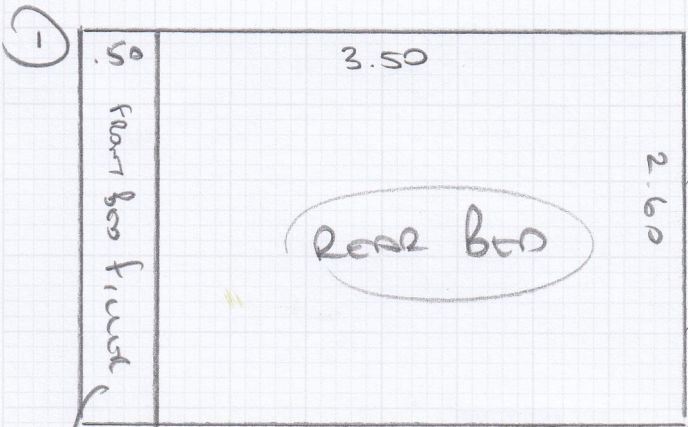

Plan ① 2.60 x 4.00

Plan ② 4.80 x 4.00



Layout

LAYS ONLY

S31619  
WICKS

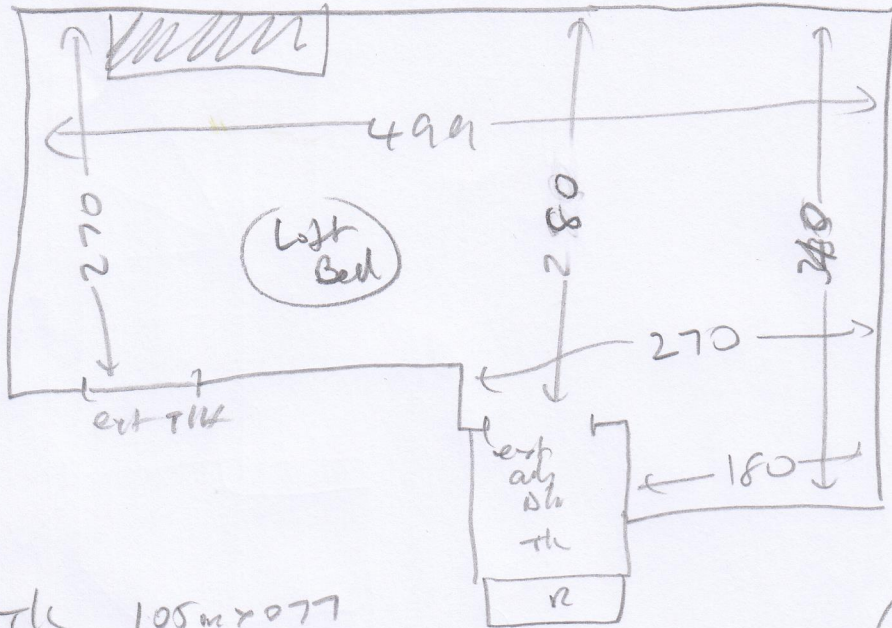

wood  
to run  
ext. needs slo  
w/ 42  
for long  
use  
separately

(4 of 4)

LAYS ONLY  
NOT REPAIRS

- tile 105m x 077

X Rise 020 x 55cm runner

① 046 x 55cm runner

- W1 064 x 092 } cut on site

- W2 073 x 109 } cut on site

W3 067 x 51cm runner

③ 046 x 51cm runner

- W4 063 x 087 } cut on site

- W5 071 x 1.08 } cut on site

W6 068 x 55cm runner

② 046 x 55cm runner

- 1st tile 1.15m x 2.55

(2nd ext. tile D12  
needs cut 2/2 +  
6mm slant)

Rise 018 x 59cm runner

② 043 x 59cm "

- W7 062 x 101 } cut on site

- W8 074 x 112 } cut on site

W9 067 x 52cm runner

⑧ } ⑨ 043 x 52cm runner  
Blk

Top stages