

FULL WOOD PANEL
 NO U/D
 2x MILK
 1x BRASS DIN

BAR TO FINISH MORE INTO LANDING THAN THE ROOM DUE TO EXISTING LAND CUT BUTTING UP TO EXISTING ROOM WOOD. - CUSTOMER TO UPLIFT WOOD.
 DOOR BAR TO GO IN RIGHT POSITION WHEN MIL IS CHANGED.

LATER DATE

- SEE NOTES PAGE

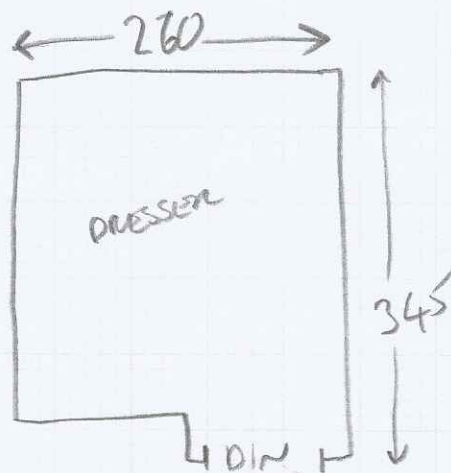
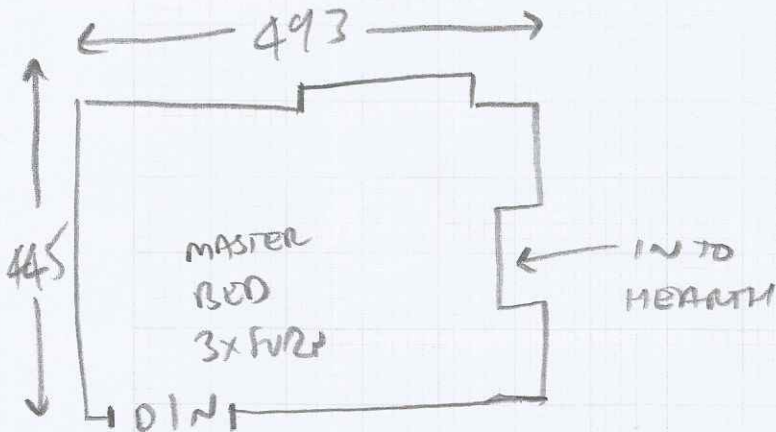

SAME HERE