

8.5 STRS = 44 x 76

LAND - WOOD

7.5 STRS = 43 x 76

LAND - WOOD

5.5 STRS = 41 x 76

LAND = WOOD

12.5 STRS = 44 x 76

WOBRY = 110 x 97 - ~~WOOD??~~

← CO12

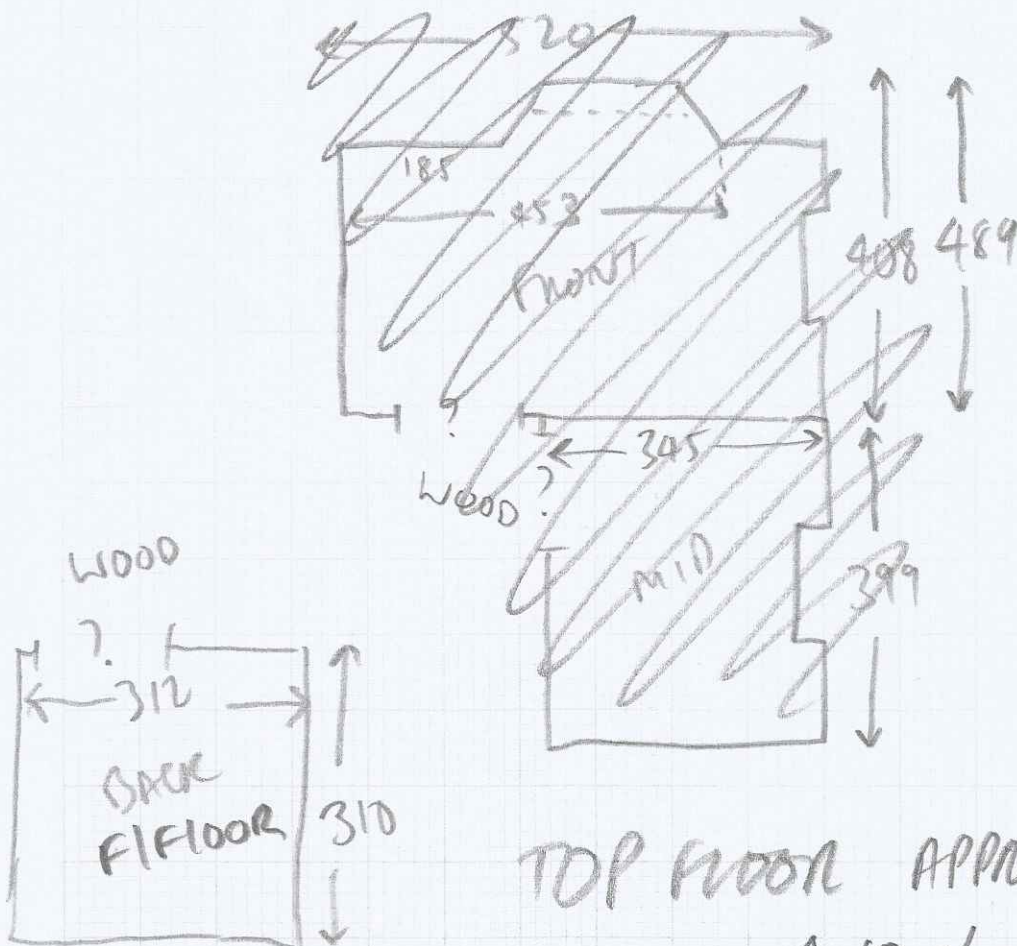

TOP FLOOR APPROX - BEST SIZES
4.10 x 4m.

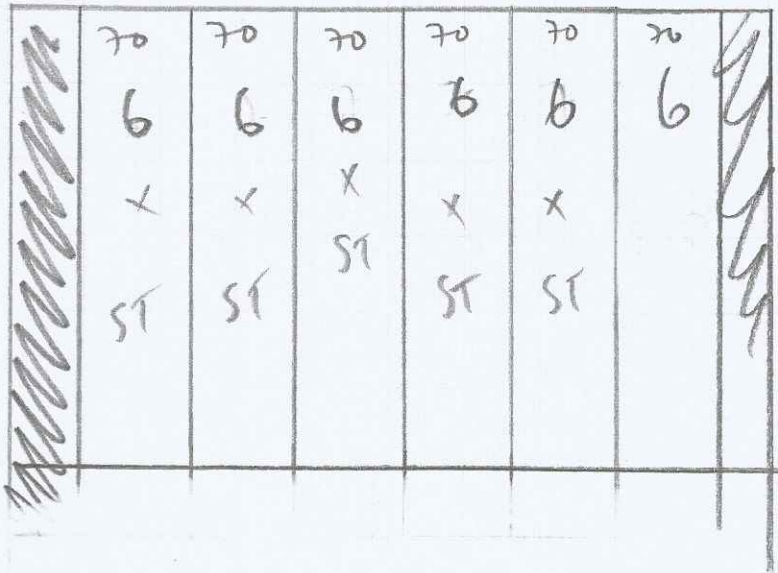

3.00 x 5.00 AU AS RUNNER
 WIDTH ~~70~~ 56 cm
 (10 cm EITHER SIDE)

J Walker & Son Developments, 6b Heslop Road

Date of Measure Tue, 27 Oct 20

At 1-1.30pm Meet build

Floor: Wood / Concrete / other _____
S/edge: Wood/Concrete/No pin/existing (if existing, allow ___ sticks to supplement where necessary)
Sticking Req'd: Yes/ No Type: Fastset/Other
Underlay: Re-use Existing / New required
Type: 42oz Felt / Fomalux / PU Foam / Luxury PU Foam / LowTog / Durafit
Doorbars: Alloy / Satin Ali / Polished Ali / Anod / Solid Brass / Chrome / Nisheen
 Seam/Wood/T/Holds: colour _____
Door Clearance: OK / Low (advise on quote)
Uplift: No / Yes (if "Yes" - what type?) _____
Furniture: No/Yes (if YES, please specify the following) - 1 man / 2 men (Fitter to get paid) £_____ total/per room
Parking Cost: Free / £_____ per hour
Parking Restrictions: (type) / £_____ *11:30 - 12:30 PERMIT*
Congestion Zone: No / Yes
Access: Easy / Hard / 2 men req'd / _____ floor?
Runners: Whipping / Binding (if binding, specify type)
Tape size: 1½" / 2" / 3" / 5"
Style: Top taping / Side binding
Stairrods: Type _____ Nr _____ Size _____

Must Read: Req Mid to end Nov

Office Ref: S32077