

Riser + 60 cm runner

1 OF 2

CUT
Runners
+
Template
on site

S32658

MRS L. ONSLOW
111 Patemall Park
E Sheen
SW14 8JJ

Nepal Karpur
KAN 622

6.25 x 5m
10.10 x 5m
6.70 x 5m

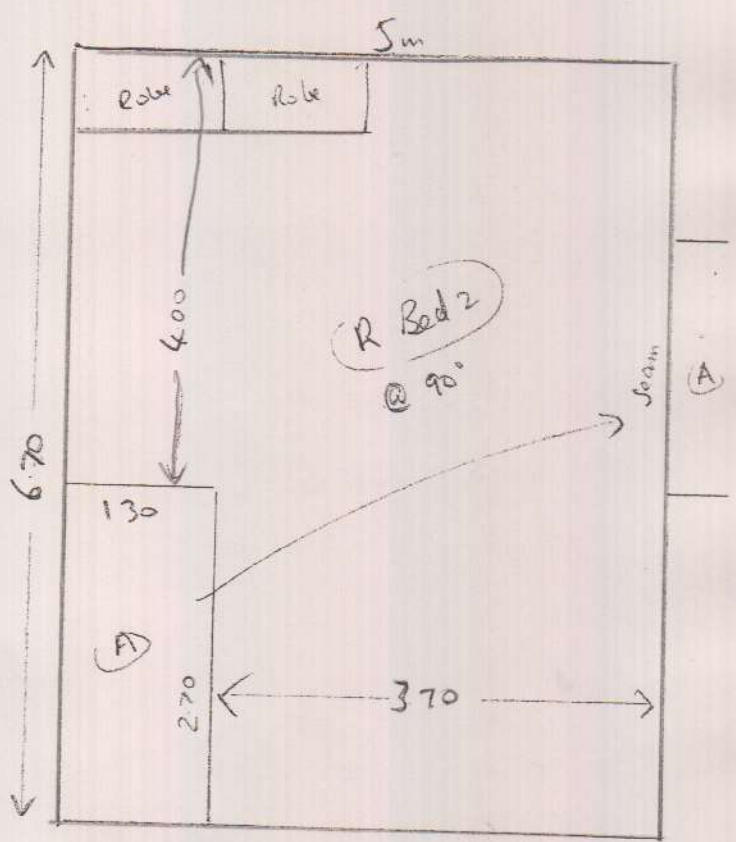

Part 1 of job
Cut runners +
template under
on site

Part 1 of job

Cut runners

S32658 Carpet

Mrs L. ONSLOW

111 Palenell Plk

Address: SW14 8JJ

Tel:

Sheet: of:

↑ Top stairs

Tot Rise	60 cm runner
①	
W1	0.73 x 1.00
W2	0.78 x 1.19
W3	0.76 x 60 cm runner
⑩	0.47 x 60 cm runner

} cut on site

These top runners
to be sent for
whipping

Bottom stairs

Rise 0.20 x 73 cm runner

⑩ 0.44 x 73 cm runner

+ access bottom where it

meets the hall.

Bottom runners
to be sent for
taping

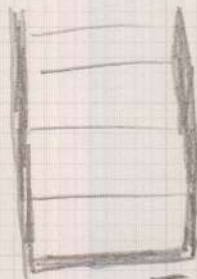

2 of 2

Whipping & Binding Workshop Instructions

Revised Prices February 2021



To: **Kasias Carpets Ltd** 07825 156676

Branch: Sheen - Tel: 020 8876 9126 E:sheenbranch@mr-carpet.co.uk

Branch Contact: John Cresswell

Customer Name: Onslow

Please quote on invoice

Job No: S32658

Please quote on invoice

Description of Carpet: Nepal Kanpur, KAN 622

Carpet Finish: Whipping SIDES ONLY

Number of Pieces: 5

Sizes to be cut to: (If applicable) Already cut runners

SHEET 1
TOP STAIRS = 60 cm WIDE
RUNNERS

Runner Lengths for Taping: Please check before sewing **TOP STAIRS FOR WHIPPING**

SEE SHEET 2 FOR BOTTOM STAIRS FOR TAPING

Date for collection: 06 October 2021

Required back by: 8/10 21

Collection From: Warehouse

Return To: Warehouse

If Tape Selected

Supplied By

Select Supplier (if Appl)

Colour of tape:

Size of Tape:

Amount Visible on Top:

If Whipping:

Colour of Whipping: Matching yarn

Special Instructions

Sewing charges authorised - Please note only charges authorised in writing will be paid on invoice

Materials	Description	Quantity	Unit Cost	Total
Whipping	Under 3m x 3m	18.00	£2.70	£48.60
	Over 3m x 3m		£2.70	
Standard Taping	Labour Only Under 3m x 3m		£6.40	
Double Taping	Labour Only Under 3m x 3m		£9.00	
Faux Suede & Leather	Labour Only Under 3m x 3m		£7.80	
Mitres Cotton	Per Corner	NOT APPLICABLE		
Mitres Leather	Per Corner	NOT APPLICABLE		
Narrow Binding THICK PILES	Labour & tape included		£7.70	
Blind Stitching MACHINE	NO LONGER AVAILABLE HAND SEWN ONLY			
Blind Stitching HAND SEWN	38mm Tape Labour & Tape		£13.00	
Hidden Stitching	Additional cost per lin M to above prices (Enter the same quantity as tape quantity)	NOT APPLICABLE		

Materials & other charges

Quantity	Description	Quantity	Unit Cost	Total
	Padding		£1.00	
	Chenille Tape 120mm		£4.40	
	Chrome Tape 120mm		£4.00	
	Cotton Tape 70mm		£3.30	
	Cotton Tape CK 120mm		£3.80	
	Cotton Herringbone HB 120mm		£4.40	
	Linen Twill Tape		£6.00	
	Faux Leather 120mm		£6.20	
	Faux Suede 120mm		£6.20	
	Goblin GLV 120mm		£4.40	
	Jute 120mm		£4.00	
	Leather 120mm		£14.00	
	Pipeline		£3.50	
	Starline (Linen) LS 120mm		£6.00	
	Superstrong 120mm		£6.00	
	Slim 120mm		£3.50	
	Teakline 120mm		£6.00	
	Sub Total			£48.60
	VAT @ 20%			£9.72
	Total			£58.32

Whipping & Binding Workshop Instructions

Revised Prices February 2021



To: **Kasias Carpets Ltd** 07825 156676
 Branch: Sheen - Tel: 020 8876 9126 E:sheenbranch@mr-carpet.co.uk
 Branch Contact: John Cresswell

SHEET 2

Customer Name: Onslow **Please quote on invoice**

Job No: S32658 **Please quote on invoice**

Description of Carpet: Nepal Kanpur, KAN 622

Carpet Finish: Top Taping SIDES ONLY

Number of Pieces: 2

Sizes to be cut to: (if applicable) Already cut runners

on long 73cm wide runner. also tapes across the bottom

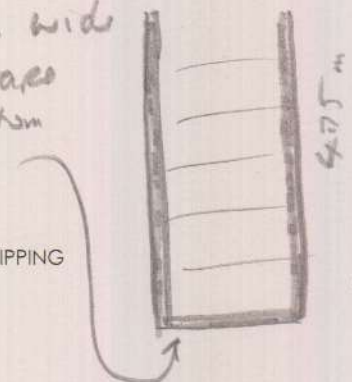

Runner Lengths for Taping: **Please check before sewing** BOTTOM STAIRS FOR TAPING SEE SHEET 1 FOR TOP STAIRS FOR WHIPPING

Date for collection: 06 October 2021 Required back by: 8/10 21

Collection From: Warehouse Return To: Warehouse

If Tape Selected	Supplied By	Select Supplier (if Appl)
Colour of tape: HB 3230	Size of Tape:	Amount Visible on Top: 5cm
If Whipping:		
Colour of Whipping:		

Special Instructions

Sewing charges authorised - **Please note only charges authorised in writing will be paid on invoice**

Materials	Description	Quantity	Unit Cost	Total
Whipping	Under 3m x 3m		£2.70	
	Over 3m x 3m		£2.70	
Standard Taping	Labour Only Under 3m x 3m	17.00	£6.40	£108.80
Double Taping	Labour Only Under 3m x 3m		£9.00	
Faux Suede & Leather	Labour Only Under 3m x 3m		£7.80	
Mitres Cotton	Per Corner	NOT APPLICABLE		
Mitres Leather	Per Corner	NOT APPLICABLE		
Narrow Binding THICK PILES	Labour & tape included		£7.70	
Blind Stitching MACHINE	NO LONGER AVAILABLE HAND SEWN ONLY			
Blind Stitching HAND SEWN	38mm Tape Labour & Tape		£13.00	
Hidden Stitching	Additional cost per lin M to above prices	NOT APPLICABLE		
	(Enter the same quantity as tape quantity)			
Materials & other charges				
Quantity	Description	Quantity	Unit Cost	
	Padding		£1.00	
	Chenille Tape 120mm		£4.40	
	Chrome Tape 120mm		£4.00	
	Cotton Tape 70mm		£3.30	
	Cotton Tape CK 120mm		£3.80	
	Cotton Herringbone HB 120mm	17.00	£4.40	£74.80
	Linen Twill Tape		£6.00	
	Faux Leather 120mm		£6.20	
	Faux Suede 120mm		£6.20	
	Goblin GLV 120mm		£4.40	
	Jute 120mm		£4.00	
	Leather 120mm		£14.00	
	Pipeline		£3.50	
	Starline (Linen) LS 120mm		£6.00	
	Superstrong 120mm		£6.00	
	Slim 120mm		£3.50	
	Teakline 120mm		£6.00	
			Sub Total	£183.60
			VAT @ 20%	£36.72
			Total	£220.32