

imrcarpet
S32750

Job: MRS S. NAAMO
 Name: 34 Ashbourne Road
 Address: London
 Tel: W5 3EH
 Sheet: of:
 Herringbone, Montreux

2.85 x 4m

Layout

- Riser 0.20 x 62cm
- 3 0.45 x 62cm
- W1 0.66 x 1.07 } cut on site
- W2 0.76 x 1.25 }
- W3 0.73 x 62cm
- 5 0.45 x 62cm
- 1/4 land 1.12m x 0.90 
- 2 0.45 x cut on site

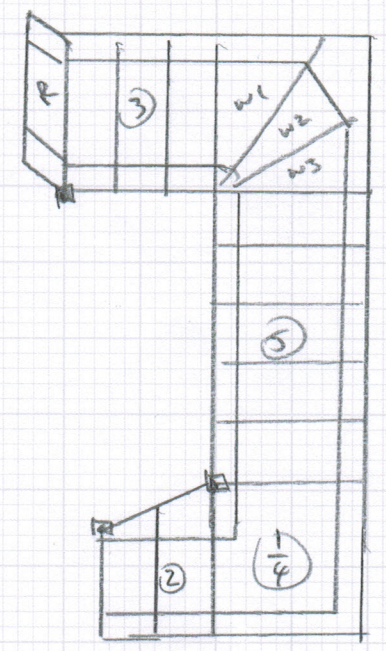

(10/21)

Whipping & Binding Workshop Instructions

Revised Prices February 2021



To: **Kasias Karpets Ltd** 07825 156676
 Branch: Sheen - Tel: 020 8876 9126 E:sheenbranch@mr-carpet.co.uk
 Branch Contact: John Cresswell

Customer Name: Naamo **Please quote on invoice**

Job No: S32750 **Please quote on invoice**

Description of Carpet: Herringbone, Montreux

Carpet Finish: Whipping SIDES ONLY

Number of Pieces: 7

Sizes to be cut to: (if Runners already cut applicable)

Runner Lengths for Taping: **Please check before sewing**

Date for collection: Required back by:

Collection From: Warehouse Return To: Warehouse

| If Tape Selected | Supplied By | Select Supplier (if Appli |
|---|---------------|---------------------------|
| Colour of tape: | Size of Tape: | Amount Visible on Top: |
| If Whipping: | | |
| Colour of Whipping: Dark colour in carpet | | |

Special Instructions

Sewing charges authorised - Please note only charges authorised in writing will be paid on invoice

| Materials | Description | Quantity | Unit Cost | Total |
|----------------------------|---|----------------|-----------|--------|
| Whipping | Under 3m x 3m | 30.00 | £2.70 | £81.00 |
| | Over 3m x 3m | | £2.70 | |
| Standard Taping | Labour Only Under 3m x 3m | | £6.40 | |
| Double Taping | Labour Only Under 3m x 3m | | £9.00 | |
| Faux Suede & Leather | Labour Only Under 3m x 3m | | £7.80 | |
| Mitres Cotton | Per Corner | NOT APPLICABLE | | |
| Mitres Leather | Per Corner | NOT APPLICABLE | | |
| Narrow Binding THICK PILES | Labour & tape included | | £7.70 | |
| Blind Stitching MACHINE | NO LONGER AVAILABLE HAND SEWN ONLY | | | |
| Blind Stitching HAND SEWN | 38mm Tape Labour & Tape | | £13.00 | |
| Hidden Stitching | Additional cost per lin M to above prices | NOT APPLICABLE | | |
| | (Enter the same quantity as tape quantity) | | | |

Materials & other charges

| Quantity | Description | Quantity | Unit Cost | Total |
|----------|-----------------------------|----------|------------------|--------|
| | Padding | | £1.00 | |
| | Chenille Tape 120mm | | £4.40 | |
| | Chrome Tape 120mm | | £4.00 | |
| | Cotton Tape 70mm | | £3.30 | |
| | Cotton Tape CK 120mm | | £3.80 | |
| | Cotton Herringbone HB 120mm | | £4.40 | |
| | Linen Twill Tape | | £6.00 | |
| | Faux Leather 120mm | | £6.20 | |
| | Faux Suede 120mm | | £6.20 | |
| | Goblin GLV 120mm | | £4.40 | |
| | Jute 120mm | | £4.00 | |
| | Leather 120mm | | £14.00 | |
| | Pipeline | | £3.50 | |
| | Starline (Linen) LS 120mm | | £6.00 | |
| | Superstrong 120mm | | £6.00 | |
| | Slim 120mm | | £3.50 | |
| | Teakline 120mm | | £6.00 | |
| | | | Sub Total | £81.00 |
| | | | VAT @ 20% | £16.20 |
| | | | Total | £97.20 |