

Layout

S32773

O'Kelly

2-OF-2

	TL	1.30m x 1.00 (ansel dn extalizer)
	L1	062 x 084
STAIRS	L2	065 x 1.02
	L3	065 x 073
	(8)	066 x 071
TOP	L4	065 x 090
	L5	068 x 1.05
	L6	062 x 070
	B/N	048 x 090

need
also
extal

change class bec
to ali?
itemise

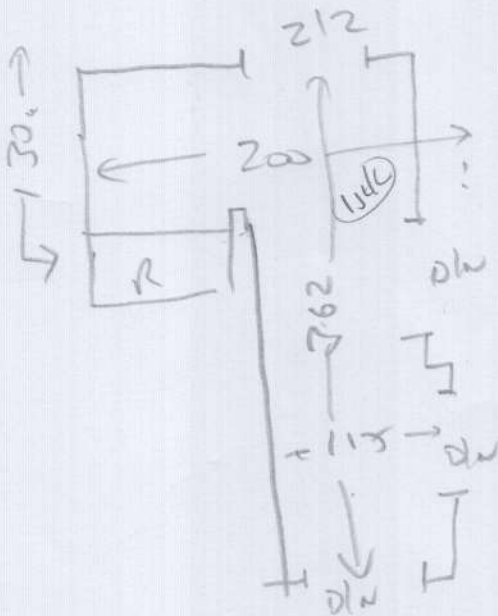

Bottom stairs	(15)	042 x 078
	B/N	045 x 1.00

(20x2)