

Job No: 534679

Name:

Address:

Tel:

Sheet: 1 / 1

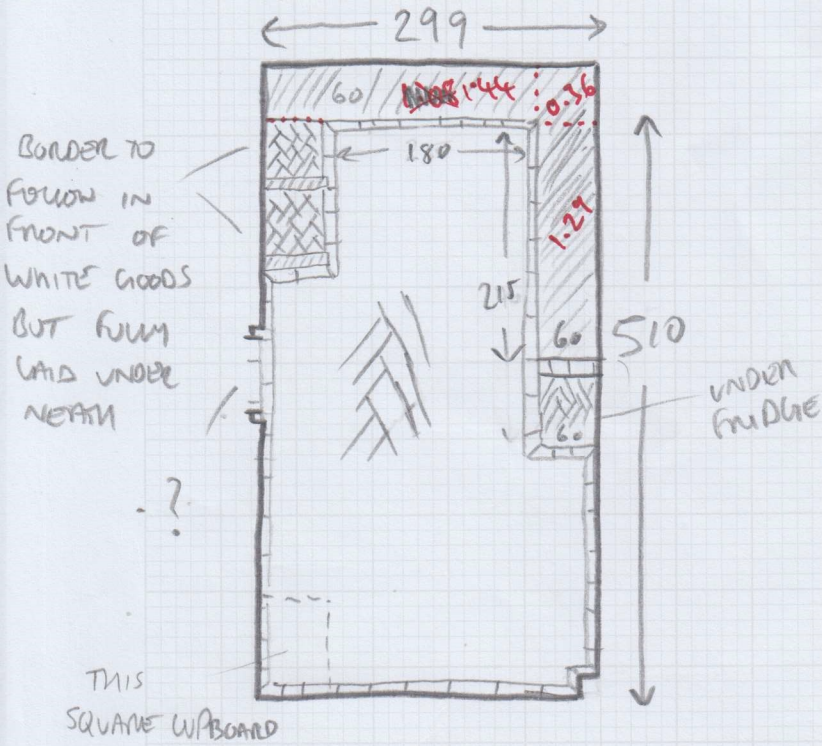

15.25m^2
 $- 1.44$
 $- 0.16$
 $- 1.29$
 12.16m^2
 $+ 15\% \text{ inc BORDER}$
 13.98m^2
 (ROUNDED UP TO
 15m^2 TO NEAREST
 FULL PACK)

ENGINEERED FLOORING DOWN. KITCHEN LAYERS TO UPLIFT.
 CONCRETE BASE FROM PROPERTY BULD. GYPSUM CONCRETE?

PRIME + SLEED CONCRETE

HOW HIGH WILL TRANSITION TO WOOD FLOOR IN HALL BE?

SUBFLOOR INSPECTION + DOOR BAR HEIGHT REQUIRE

FURTHER SITE VISIT

DOOR BAR TBC