

3 CUTS - BREAKDOWN

TOTAL OF (4 CUT) ISSUES

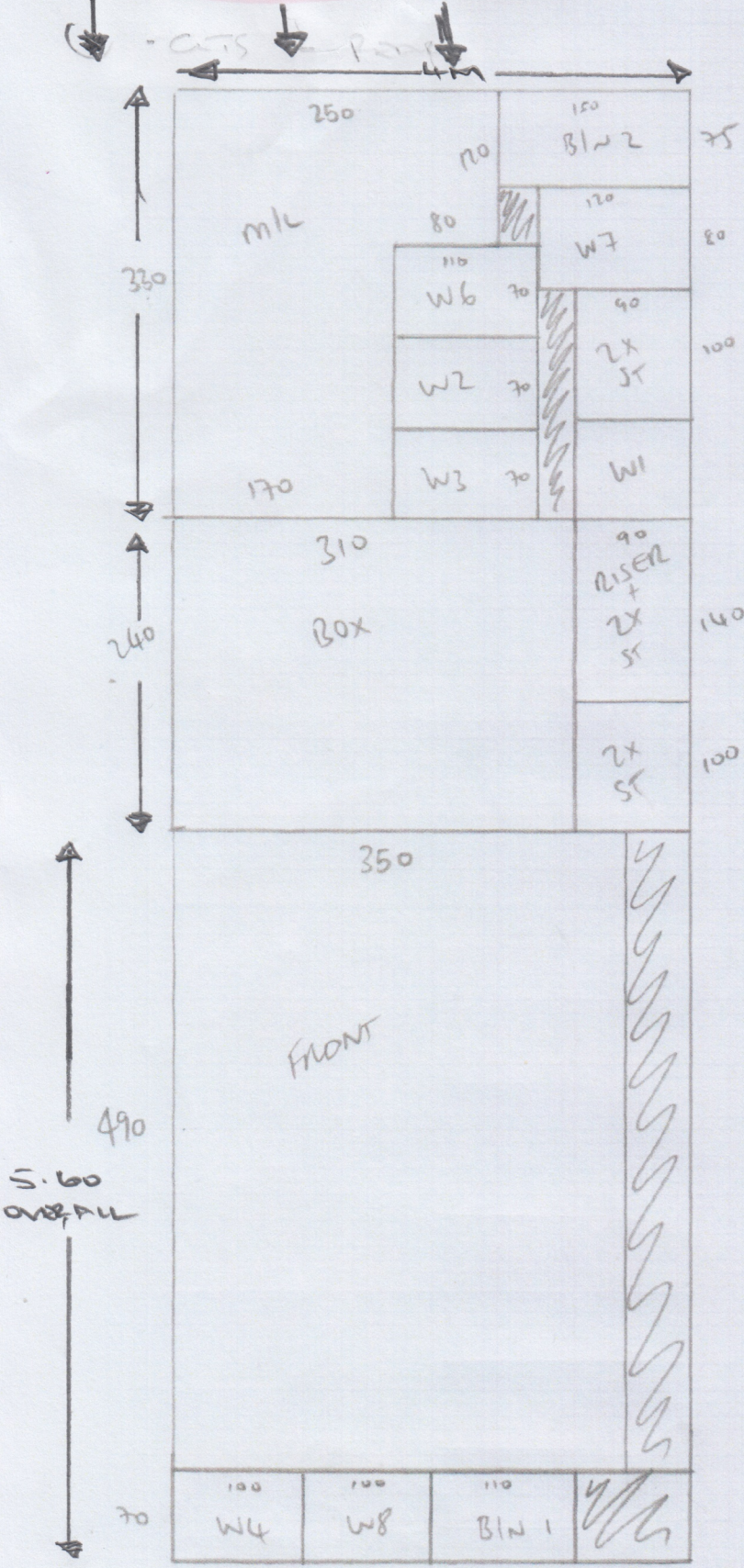

S35162  
GRAND FIELD

2/2

\* 3 CUTS - SEE \* PLAN  
11.30 x 400 - PLAN

5.30 x 400 - REAR BED

16.60 x 400m

66.40 m<sup>2</sup>

TOTAL OF (4) CUTS ALLOCATED

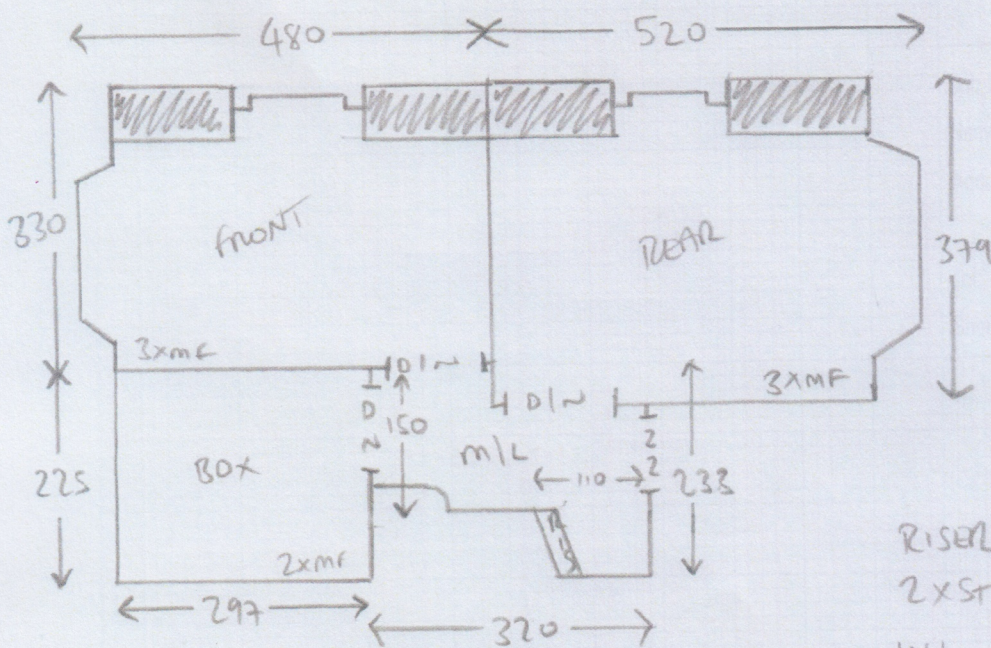

535162  
GRAND FIELD

1/2

- RISER = 18 x 73
- 2xST = 45 x 76
- W1 = 55 x 79
- W2 = 57 x 104
- W3 = 55 x 104
- W4 = 56 x 75
- 2xST = 45 x 75
- W5 = 53 x 79
- W6 = 55 x 79
- W7 = 67 x 106
- W8 = 57 x 74
- BIN 1 = 50 x 91
- BIN 2 = 65 x 135

LVT CLICK + BEARING  
ON WHOLE 1ST FLOOR  
TO REMOVE - QUITE EASY.

2/2 @ MILAND

TAKE UP TRIM HERE + PUT 22. ADVISED NO RESPONSIBILITY  
IF TILES CRACK. CUST HAS SPARE TILES IN  
STORAGE