

S35626

1/2

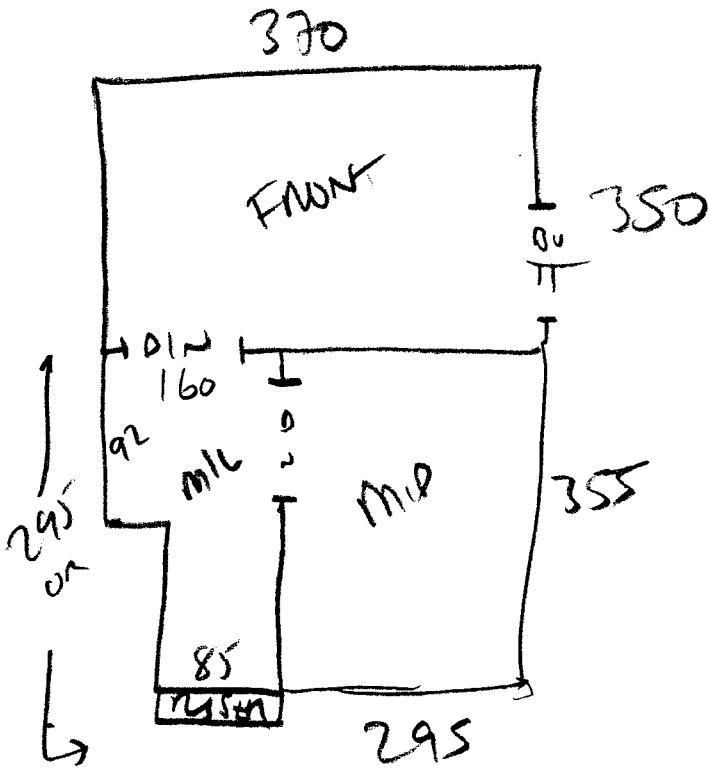

$$1 \times 55 = 45 \times 66$$

$$\text{LOBBY} = 89 \text{ or } 95 \text{ MLC} \quad 1 \times 51 \text{ N}$$

$$W1 = 62 \times 76$$

$$W2 = 68 \times ~~74~~ 91$$

$$W3 = 62 \times 65$$

$$8 \times 55 = 45 \times 65$$

$$31 \text{ N} = 45 \times 85$$

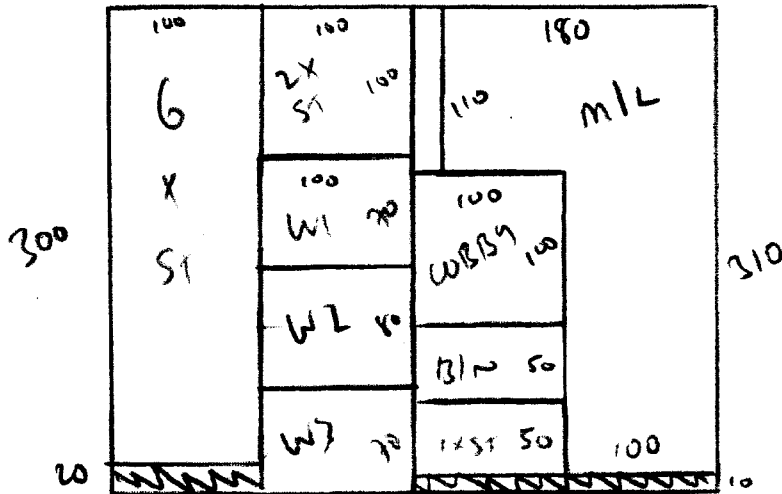

S35626

2/2

320 x 400
STANDS 12.80
M²

(370)
365 x 400 - FRONT

27 M²

310 x 400 - MID
(370)

2X BEDS

8m x 0.60m WIDE SISAL

RUNNER ON SITE (CUT ENDS OFF)

6.5 + 5.5 STRAIGHT STAIRS TO BASEMENT

COIL TO BASEMENT LOBBY IN
BETWEEN 6.5 + 5.5 STAIRS

STAIR WOODS ON SITE TO FIT.