

S35948

~~NET NUMBER NEEDED~~

~~WAS S36819~~

HORTIN-MASTIN

2-OF-2

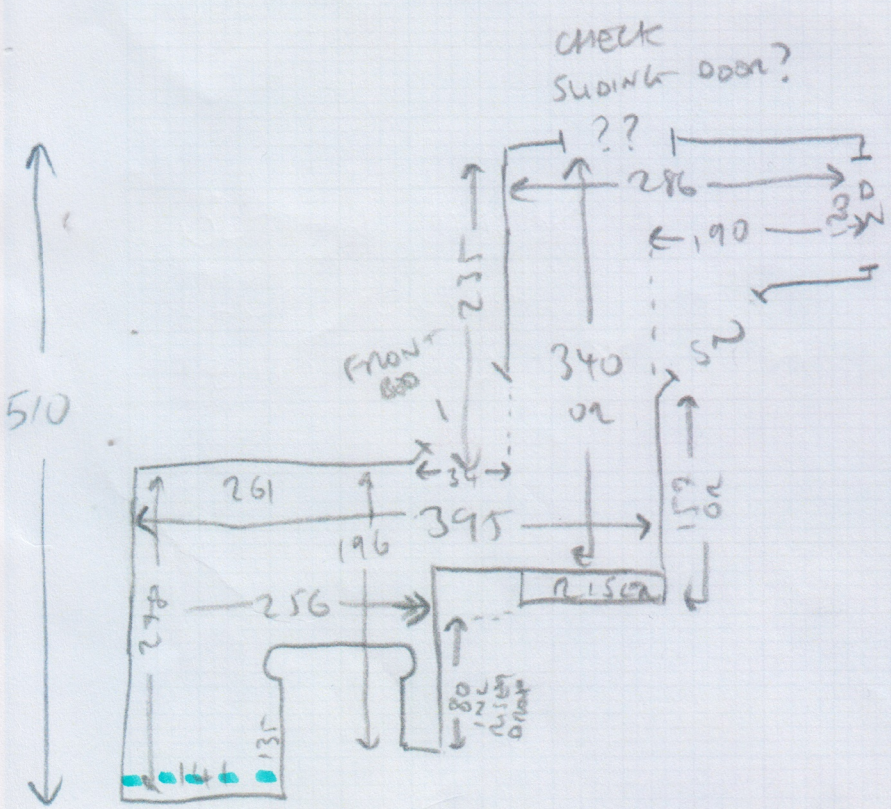
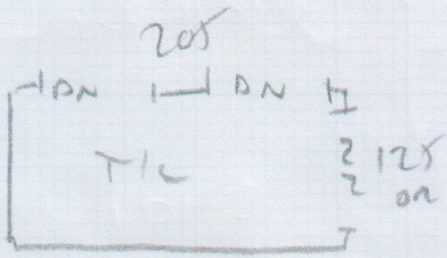

- ✓ TIL = PLAN
- ✓ W1 = 61 x 85
- ✓ W2 = 70 x 108
- ✓ W3 = 67 x 77
- ✓ 4xST = 45 x 80
- ✓ W4 = 67 x 91
- ✓ W5 = 70 x 105
- ✓ W6 = 64 x 68
- ✓ 3xST = 45 x 75
- ✓ MIL = PLAN
- ✓ 5xST = 45 x 87
- ✓ 1/4 = 110 OR x 90
- ✓ 5xST = 45 x 87
- ✓ 1/4 (B) = 110 OR x 90
- ✓ 3xST = 45 x 87

SELECTION

WESTEX ULTIMA TWIST MAJOR
"CROFT GREEN"