

W12732 -
 Designer CAROL L
 Moore
 15 Mansel Road
 SW19 4AA

Chelsea
Col. Sherwood

Cut Plan 645x500
 = 32.25M²

*** = MARK up & store
 @ WH until filling on 12/12

Binding tape: -

Runners = 3370Ln
 Lower 1/2 LAND = 560Ln

 3930Ln

²⁴¹¹ ** Shape this half landing
 on side maintaining an equal
 11cm gap all round to
 match the runners.

u/Lay: -

fomalux for Mainland = 8.50m²
 Heavy rubber for Runners
 & 2 x 1/2 LANDS = 19.50m²

* 25/11
 Cut runners down @ WH
 to match Half landings,
 MARK up & send to Kasia's
 for Binding ASAP.

ALL
 Ancillaries Booked
 out on W12754

Fit new DIN on bath side of Door frame

BATH To be tiled at future date

W12732
Designer CAROL L Moore
15 Mansel Road
SW19

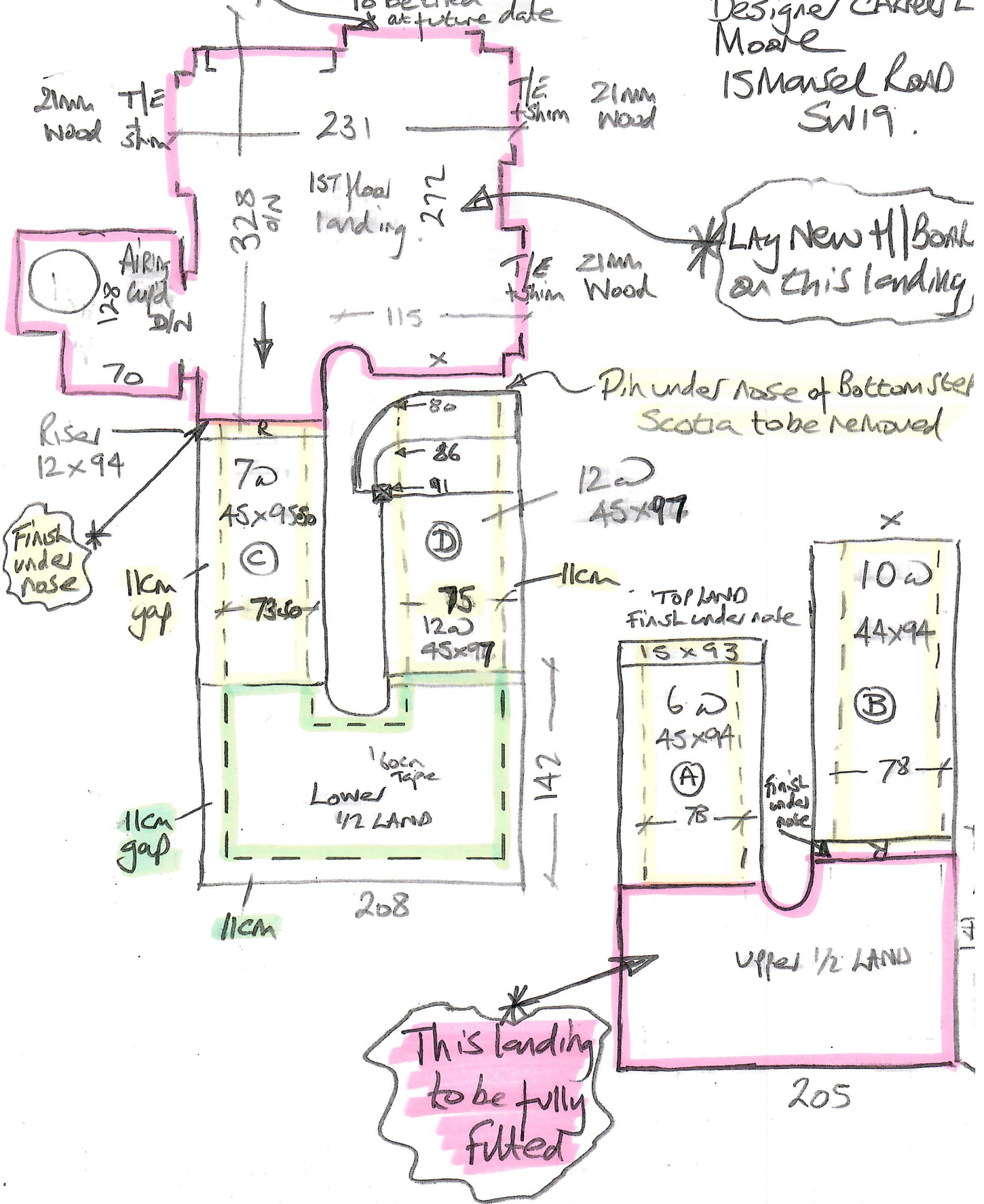

LAY New H/BOR on this landing

Pin under nose of Bottom Steel Scotia to be removed

Finish under nose

This landing to be fully fited